

Anzugsmoment
Fastning torque: 250 Ncm

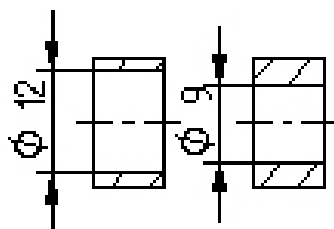

Anzugsmoment
Fastning torque: 75-100 Ncm

Anzugsmoment
Fastning torque: 75-100 Ncm

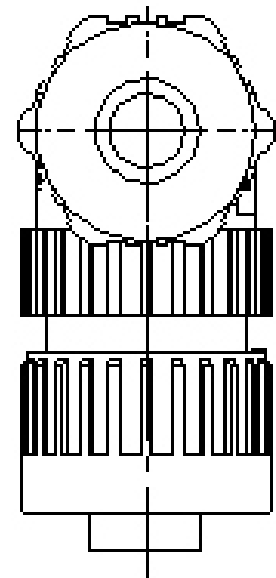
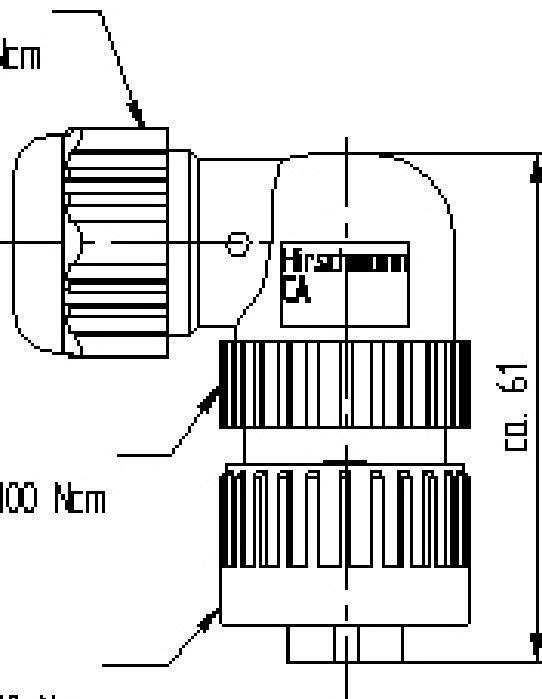

The information/details in this datasheet merely contain general descriptions or performance factors which, when applied in an actual situation, do not always correspond with the described form, and may be amended by way of the further development of products. The desired performance factors shall only be binding if these are expressly agreed on conclusion of the contract.

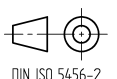

Product description

Description	Cable socket straight
Type	CA 6 W LD
Order No	934-131-100
Type of contacts	female
Number of contacts	6+PE*
Cable gland	TR22
Strain-relief	clamping cage
	60N with cable-Ø: 6 - 9 mm
	100 N with cable-Ø: 9 - 12 mm
Conductor size	max. 0,75 mm ²
Color housing	black

* Ground leading

Technical data

Clearance / Creepage distance	DIN EN 60664-1 (2008/01); VDE 0110-1
Rated voltage	250V AC/DC ***
Rated current *	10 A
Rated impulse voltage	4,0 kV
Pollution degree	3 acc. to DIN EN 60664-1 (VDE 0110-1)
Type of connection	solder
Suitable cables	Ø6 mm to Ø12 mm
	Gasket Ø9 mm for cables with Ø6 - 9 mm
	Gasket Ø12 mm for cables with Ø9 - 12 mm

* Notice derating

*** IEC-Standard Voltages acc. to DIN IEC 60038 (VDE 0175)

Materials

Contact	CuZn
Contact plating	Cu/Ag
Contact bearer	PA 66 GF, black
Housing	PA 66/6, black
Gasket(s)	NBR
Coupling screw	PA 66 GF, black
Coupling nut	PA 66/6, black

Environmental conditions

Protection class (IEC 60529) *	IP65, IP67 *
Temperature range (connector)	-40°C to +90°C, notice derating
Temperature range (gasket)	-40°C to +90°C

* only if mounted and locked in combination with Hirschmann / Lumberg connector.

Flammability class

Housing	UL 94 V-0
Contact bearer	UL 94 V-0
Coupling screw	UL 94 V-0
Coupling nut	UL 94 V-0

Approvals

VDE	yes
UL	E95522, Series CA 3

Accessories

Mating connectors / fitting to	.
	CA 6 LS : 934-126-100, cable plug straight
	CA 6 GS : 932-326-100, appliance plug
	CA00 SD 3: 831-532-400, cap

Additional technical data

Fastening torque (cable gland)	TR22: min. 250 Ncm
--------------------------------	--------------------

Cutline

Do not connect or disconnect under load.

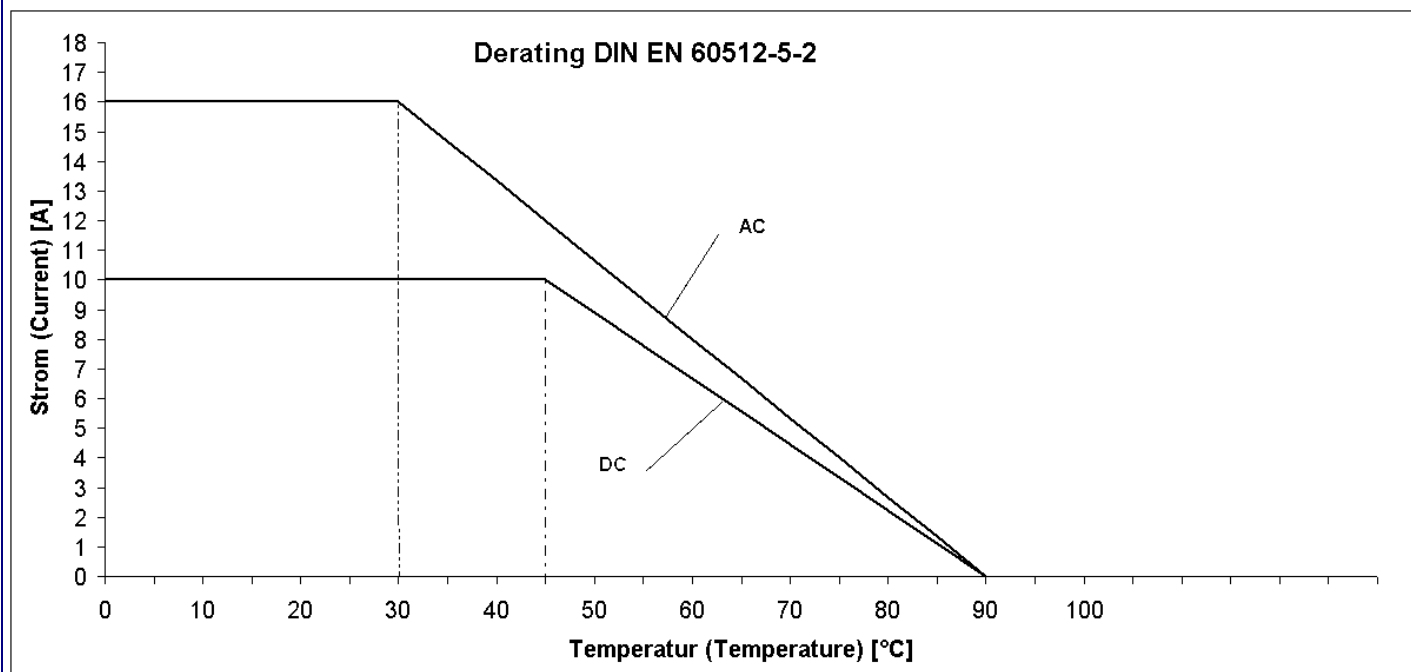

Standard products

Artikel-No.	Type
934-131-100	CA 6 W LD