

**RoHS** ✓

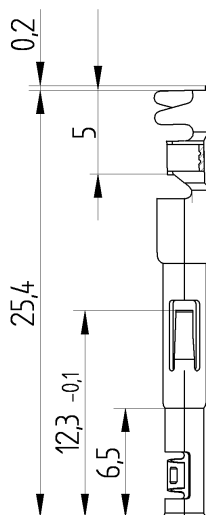

The information/details in this datasheet merely contain general descriptions or performance factors which, when applied in an actual situation, do not always correspond with the described form, and may be amended by way of the further development of products. The desired performance factors shall only be binding if these are expressly agreed on conclusion of the contract.

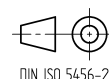

**Product description**

Description	Crimp contact
Type	RBC 162/1
Order No	733-383-021
Type of contacts	female
Conductor size	0,14 mm <sup>2</sup> - 0,50 mm <sup>2</sup>
Wire stranding	0,14 mm <sup>2</sup> : 70 x 0,05 mm
	0,25 mm <sup>2</sup> : 31 x 0,10 mm
	0,34mm <sup>2</sup> : 7 x 0,25 mm
Color contact bearer	0,50 mm <sup>2</sup> : 28 x 0,15 mm

**Technical data**

Type of connection	crimp, BO-crimp
Mating cycles	max. 50

**Materials**

Contact	CuZn
Contact plating	Cu/Ag

**Accessories**

Mating connectors / fitting to	connectors of NR-series and ST-series
Accessories to order separately	ejection tool: XWA 164
	crimping tool: 932507005 - XZC 0704

## Standard products

Artikel-No.	Type
733-383-021	RBC 162/1 Ag