

Rippe parallel zu einer  
Schlüsselfläche ausrichten/  
adjust the rib parallel to  
one of the spanner flats

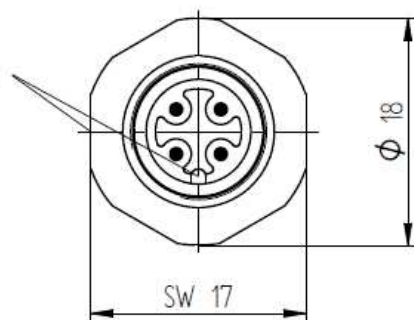

Typ/ type	Standard - Kontaktbelegung/ standard contact assignment	
	Polzahl/ number of poles	Farbkennung/ colour code
RSFM 3/ M	3 	1 = braun / brown 3 = blau / blue 4 = schwarz / black
RSFM 4/ M	4 	1 = braun / brown 2 = weiß / white 3 = blau / blue 4 = schwarz / black
RSFM 5/ M	5  voreilend / leading	1 = braun / brown 2 = weiß / white 3 = blau / blue 4 = schwarz / black 5 = grün/gelb / green/yellow
RSFM 5B/ M	5  voreilend / leading	1 = braun / brown 2 = weiß / white 3 = blau / blue 4 = schwarz / black 5 = grün/gelb / green/yellow

The information/details in this datasheet merely contain general descriptions or performance factors which, when applied in an actual situation, do not always correspond with the described form, and may be amended by way of the further development of products. The desired performance factors shall only be binding if these are expressly agreed on conclusion of the contract.

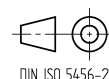

**Product description**

Description	<ul style="list-style-type: none"> <li>- receptacle connector for front mounting</li> <li>- M12 and FIXCON ® intermateable</li> <li>- assembled stranded wire "L"</li> <li>- chassis side thread M16x1,5</li> <li>- color coding of the conductor acc. to Euro-standard</li> </ul>
Type	RSFM ../... M, see standard products page 3
Order No	see standard products page 3
Type of contacts	male
Number of contacts	3; 4; 5, see standard products page 3
Standard	IEC 61076-2-101
Construction type	EM

**Technical data**

Rated voltage	250 V, 3 and 4 pin 60 V, 5 pin (UL: 30V)
Rated current *	4 A
Rated impulse voltage	2,5 kV, 3 and 4 pins 1,5 kV, 5 pins
Pollution degree	3 acc. to DIN EN 60664-1 (VDE 0110-1)
Contact resistance	≤ 5 mOhm
Insulation resistance	> 10 <sup>9</sup> Ohm

\* Notice derating

**Materials**

Housing	CuZn, nickel plated
Contact bearer	PA
Contact	CuZn
Contact plating	Ni/Au
O-ring	FKM

**Environmental conditions**

Protection class (DIN 40050 Teil 9) *	IP 69 K
Protection class (IEC 60529) *	IP 67
Temperature range	-25°C to +80°C

Good chemical resistance.

The resistance has to be checked in individual cases.

\* only if mounted and locked in combination with Hirschmann / Lumberg connector.  
on the installation side tightness has to be assured by taking proper measures

**Cutline**

\* a o-ring enclosed separately

\* b solder contacts potted with epoxy

"L" = standard length of stranded wire

further technical information on stranded wires see 908...

Do not connect or disconnect under load.

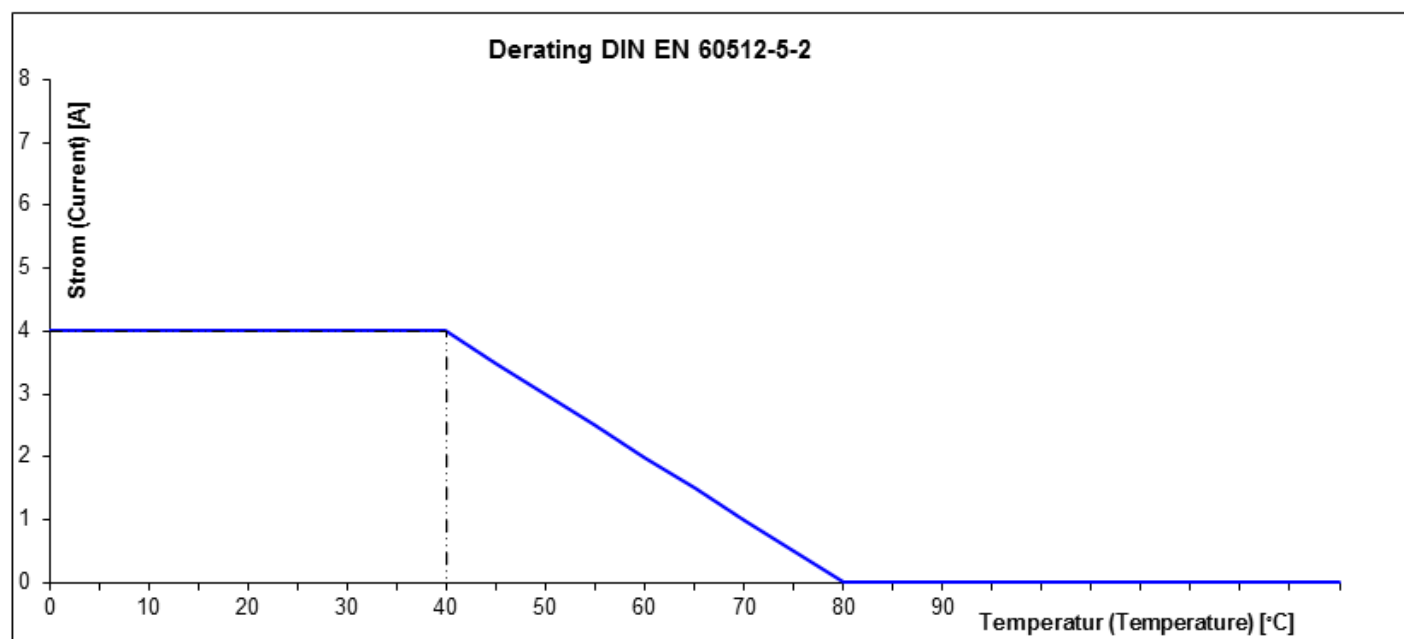

#### Standard products

Artikel-No.	Type
000-005-253	RSFM 5/0,14 M
000-015-624	RSFM 4/1 M
000-026-142	RSFM 3/0,5 M
000-026-144	RSFM 4/0,5 M
000-026-146	RSFM 5/0,5 M
000-083-983	RSFM 5/1 M
000-096-551	RSFM 5B/0,5 M
000-097-392	RSFM 5/0,15 M
000-104-384	RSFM 4/2 M
000-108-897	RSFM 5/2 M
934-636-300	RSFM 3/1,5 M