

Product information

RKCW.../13,5 - RKCW 190/13,5

Industrial Connecting Solutions: Circular Connectors: 7/8", M23 Connectors: M23 Connectors: Field Attachable M23 Connectors: Female Connectors: RKCW.../13,5
<https://www.e-catalog.beldensolutions.com:443/link/57078-24228-256281-256289-248941-279256-279261-277806/en/RKCW190-135/ui/state>

Name	RKCW.../13,5
	
	Field Attachable Connector, M23 female right angle connector with threaded joint, assembling with solder connections, Screw joint for cable PG 13,5; 19-poles.
Delivery informations	
Availability	available
Product description	
Type	RKCW 190/13,5
Order No.	2207
Description	Field Attachable Connector, M23 female right angle connector with threaded joint, assembling with solder connections, Screw joint for cable PG 13,5; 19-poles.
Number of contacts	19
Product characteristics	Vibration resistance, Oil resistance, Drag chains suitable, EMC resistance, UV resistance
Mechanical data	
Type of plug-in contact	Female connector
Thread	M23
Design of electrical connection	connector M23
LED display present	✗
Environmental conditions	
Environmental temperature	-40 °C ... 125 °C
Degree of protection (IP), mounted	IP67
Pollution degree	3
Materials	
Housing material / Molded body	CuZn, nickel-plated
Contact bearer material	PBT
Contact material	CuZn
Contact material - Surface refinement	pre-nickel and gold-plated
Knurled screw / nut material	CuZn, nickel-plated
Electrical data	
Rated current In	7.5 A (7.5 A - pin-Ø 1.0 mm; 10 A - pin-Ø 1.5 mm)
Nominal voltage	120 V
Rated voltage	125 V
Test voltage	1.5 kV eff./60 s
Insulation resistance	> 10 GΩ
Approvals	
RoHS 2002/95/EG compliant	RoHS 2002/95/EG
Cable	
Diameter of conductor	0.2 mm

Industrial Connecting Solutions: Circular Connectors: 7/8", M23 Connectors: M23 Connectors: Field Attachable M23 Connectors: Female Connectors: RKCW.../13,5
<https://www.e-catalog.beldensolutions.com:443/link/57078-24228-256281-256289-248941-279256-279261-277806/en/RKCW190-135/uistate>

Picture

Drawing

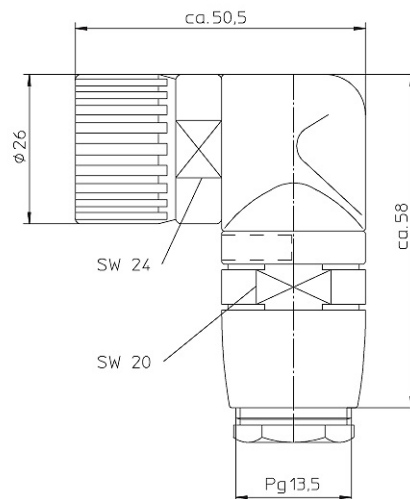

**12-polig
12 poles**



**19-polig
19 poles**

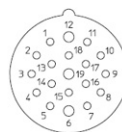

Belden Deutschland GmbH
Im Gewerbepark 2
58579 Schalksmühle
Germany
Phone: +49 7127/14-1806
E-Mail: icos-sales@belden.com

The information published in the websites has been compiled as carefully as possible. It is subject to alteration without notice in technical as well as in price-related/commercial respect. The complete information and data were available on user documentation. Mandatory information can only be obtained by a concrete query.