

RoHS  

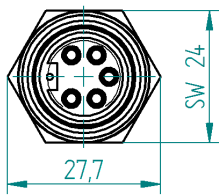
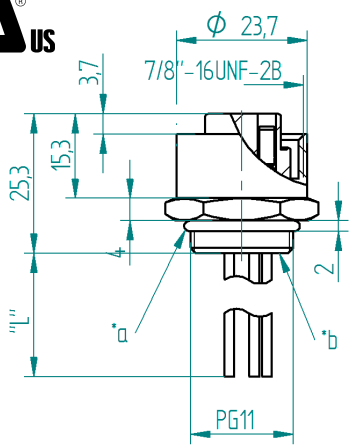
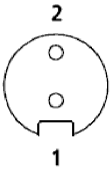
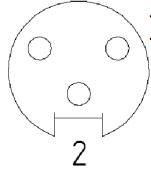
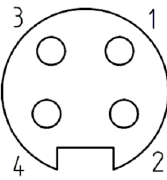
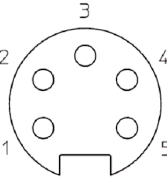

Legende/ cutlinde  
\*a O-Ring/ o-ring  
\*b Anschlussbereich vergossen/  
Solder contacts epoxy potted  
"L" Standardlänge der Schaltlitze/  
standard length of stranded hook-up wire

| Typ/<br>type | Kontaktbelegung/<br>contact assignment   |   |
|--------------|--|---|
|              | Polzahl/<br>number of poles  | Farbkennung/<br>color code  |
| RKF 20       | 2<br> | 1 = braun / brown<br>2 blau / blue  |
| RKF 30       | 3<br> | 1 = braun / brown<br>2 = schwarz / black<br>3 = blau / blue   |
| RKF 40       | 4<br> | 4 = braun / brown<br>5 = weiß / white<br>6 = blau / blue<br>7 = schwarz / black                                 |
| RKF 50       | 5<br> | 1 = schwarz / black<br>2 = blau / blue<br>3 = grün-gelb / green-yellow<br>4 = braun / brown<br>5 = weiß / white |

The information/details in this datasheet merely contain general descriptions or performance factors which, when applied in an actual situation, do not always correspond with the described form, and may be amended by way of the further development of products. The desired performance factors shall only be binding if these are expressly agreed on conclusion of the contract.



## Product description

|                  |   |
|------------------|---|
| Description      | 7/8" receptacle female connector<br>- for front mounting<br>- assembled stranded wire "L" |
| Type             | RKF.../11-..., see last page(s)   |
| Order No         | see last page(s)  |
| Type of contacts | female  |

## Technical data

|                       |  |
|-----------------------|--|
| Rated voltage         | 240 V  |
| Rated current *       | 12 A (2-3 poles) on 40°C<br>9 A (4-5 poles) on 40°C                          |
| Rated impulse voltage | 2,0 kVeff / 60 s (2-3 poles) on 40°C<br>1,5 kVeff / 60 s (4-5 poles) on 40°C |
| Pollution degree      | 3 acc. to DIN EN 60664-1 (VDE 0110-1)  |
| Contact resistance    | ≤ 5 mOhm   |
| Insulation resistance | > 10 <sup>9</sup> Ohm  |

\* Notice derating

## Materials

|                 |                        |
|-----------------|------------------------|
| Housing         | CuZn, nickel-plated    |
| Contact bearer  | TPU, orange            |
| Contact         | CuZn                   |
| Contact plating | silver and gold plated |
| O-ring          | Neoprene               |

## Environmental conditions

|                                |                                      |
|--------------------------------|--------------------------------------|
| Protection class (IEC 60529) * | IP68 (1h, 10 bar)                    |
| Temperature range (connector)  | -25 °C to +90 °C **, notice Derating |

\* only if mounted and locked in combination with Hirschmann / Lumberg connector.

\*\* Temperature resistance of the stranded wire considered separately

## Cable-data

|           |  |
|-----------|--|
| Cabletype | see last page(s)   |
|           | Stranded hook-up wire 01, Cable jacket: PVC,<br>outer diameter D= 2,40 mm,<br>conductor cross-section 0,75 mm <sup>2</sup> |
|           | Stranded hook-up wire 02, Cable jacket: PVC,<br>outer diameter D= 1,80 mm,<br>conductor cross-section 0,50 mm <sup>2</sup> |

Further types on request.

Further technical information on Stranded hook-up wires see 908...

## Cutline

Do not connect / disconnect under load.

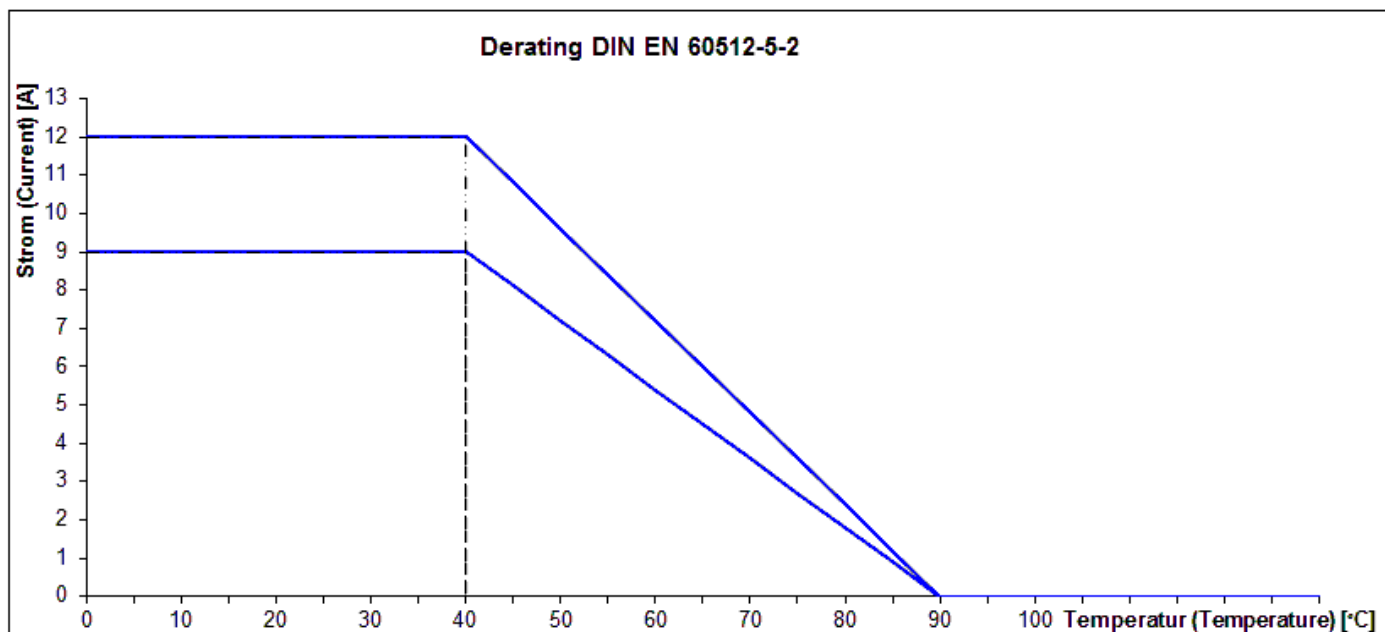

**Standard products**

| Artikel-No. | Type         | Wire specification | Wire length L |
|-------------|--------------|--------------------|---------------|
| 000-011-263 | RKF 30/11-05 | 90801              | 0,3 m         |
| 000-011-268 | RKF 40/11-02 | 90809              | 0,3 m         |
| 000-011-271 | RKF 50/11-04 | 90809              | 0,3 m         |
| 000-012-930 | RKF 20/11-03 | 90801              | 0,3 m         |