

RoHS 

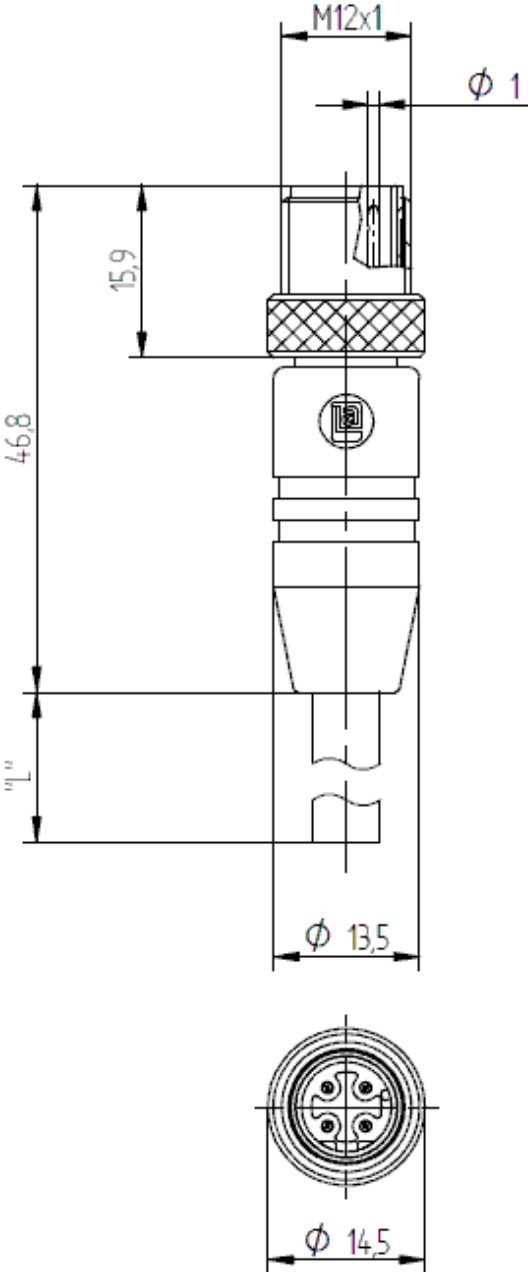

Legende/ cutline
 "L" Standardlänge der Steuerleitung
 standard length of cable

Typ/ type	Standard - Kontaktbelegung/ standard contact assignment	
	Polzahl/ number of poles	Farbkennung/ color code
M12	4	1 = gelb/ yellow
		2 = weiß/ white
		3 = orange/ orange
		4 = blau/ blue

The information/details in this datasheet merely contain general descriptions or performance factors which, when applied in an actual situation, do not always correspond with the described form, and may be amended by way of the further development of products. The desired performance factors shall only be binding if these are expressly agreed on conclusion of the contract.

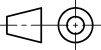
DIN ISO 5456-2

Product description

Description	M12 connector with molded cable - 360° shielding connected to knurled nut
Type	0985 342 102/...M, see page 3
Order No	see page 3
Type of contacts	male
Standard	IEC 61076-2-101 D
Construction type	LM, D coded

Technical data

Mating cycles	≤ 100
Rated voltage	250 V AC/DC
Rated current *	4 A
Rated impulse voltage	2,0 kV
Pollution degree	3 acc. to DIN EN 60664-1 (VDE 0110-1)
Contact resistance	≤ 5 mΩ
Insulation resistance	> 10 ⁹ Ω

* Notice derating

Materials

over molding	TPU, black
Contact bearer	PBT black
Contact	CuSn
Contact plating	Cu/Au
Knurled screw	CuZn, nickel-plated
Shielding sleeve	CuZn, tin-plated

Environmental conditions

Protection class (IEC 60529) *	IP67
Temperature range (connector)	-25°C to +80°C, notice Derating **
Temperature range (cable, hard-wired)	-50 °C to +80 °C
Temperature range (cable, moved)	-25 °C to +80 °C

Good chemical resistance.

The resistance has to be checked in individual cases.

* only if mounted and locked in combination with Hirschmann / Lumberg connector.

** Temperature resistance of the cable considered separately

Cable-data

Cabletype	STL 342, Cable jacket: PUR outer diameter D= 6,5 mm, drag chain qualified
-----------	--

Further types on request.

Further technical information on control lines see 909 342

Cutline

Do not connect or disconnect under load.



Standard products

Artikel-No.	Type
000-002-228	0985 342 102/40 M
000-002-781	0985 342 102/20 M
000-011-833	0985 342 102/1,5 M
000-012-003	0985 342 102/35 M
000-012-024	0985 342 102/45 M
000-012-025	0985 342 102/50 M
000-015-640	0985 342 102/7,5 M
000-075-631	0985 342 102/2 M
000-075-632	0985 342 102/5 M
000-077-830	0985 342 102/10 M
000-091-037	0985 342 102/3 M
000-097-265	0985 342 102/2,05 M
000-097-266	0985 342 102/5,05 M
000-097-267	0985 342 102/10,05 M
934-636-087	0985 342 102/25 M
934-636-134	0985 342 102/15 M
934-636-933	0985 342 102/1 M
934-637-566	0985 342 102/30 M