

RoHS  

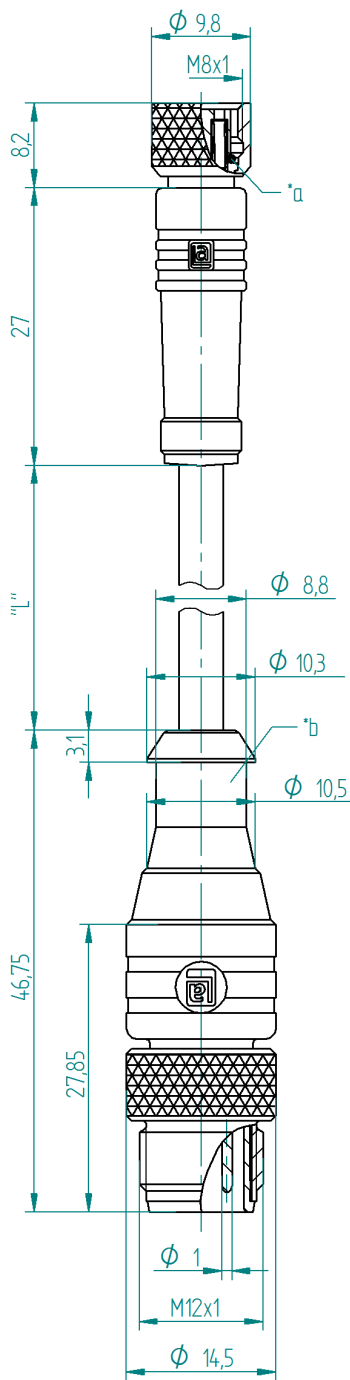

Typ/ type	Kontaktbelegung/ contact assignment	
	Polzahl/ number of poles	Farbkennung/ color code
RST		4 = schwarz / black
		3 = blau / blue
		1 = braun / brown
RKMV		4 = schwarz / black
		3 = blau / blue
		1 = braun / brown

The information/details in this datasheet merely contain general descriptions or performance factors which, when applied in an actual situation, do not always correspond with the described form, and may be amended by way of the further development of products. The desired performance factors shall only be binding if these are expressly agreed on conclusion of the contract.

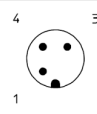
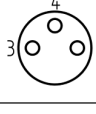

Product description

Description	- cordset double-ended, M12 male connector and M8 female connector with self-locking threaded joint - colour coding of the conductor acc. to Euro-standard
Type	RST 3-RKMV 3-.../*M
Type of contacts	RST: male RKMV: female
Number of contacts	RST: 3 RKMV: 3
Standard	IEC 61076-2-101 / IEC 61076-2-104
Construction type	RST: LM RKMV: LF

Technical data

Operating voltage	60 V
Rated voltage	63 V
Rated current *	4 A
Rated impulse voltage	1,5 kV
Pollution degree	3 acc. to DIN EN 60664-1 (VDE 0110-1)
Contact resistance	$\leq 5 \text{ m}\Omega$
Insulation resistance	$> 10^9 \Omega$

* Notice derating

Materials

Contact bearer	TPU, orange
over molding	TPU, translucent
Contact	RST: CuSn RKMV: CuZn
Contact plating	Cu/Au
Knurled screw	CuZn, nickel-plated
Knurled nut	CuZn, nickel-plated
O-ring	FKM

Environmental conditions

Protection class (IEC 60529) *	RST: IP67 RKMV: IP67/ IP69K
Temperature range	-25°C to +80°C, notice derating

Good chemical resistance.

The resistance has to be checked in individual cases.

* only if mounted and locked in combination with Hirschmann / Lumberg connector.

Additional technical data

Fastening torque (coupling nut)	M8x1: 30 Ncm, hand-tight
Fastening torque (coupling screw)	M12x1: 50 Ncm, hand-tight

Cutline

Do not connect / disconnect under load.

*a O-ring

*b hose mounting

L = length of control line

Further technical information on the control line see datasheet 909-xxx

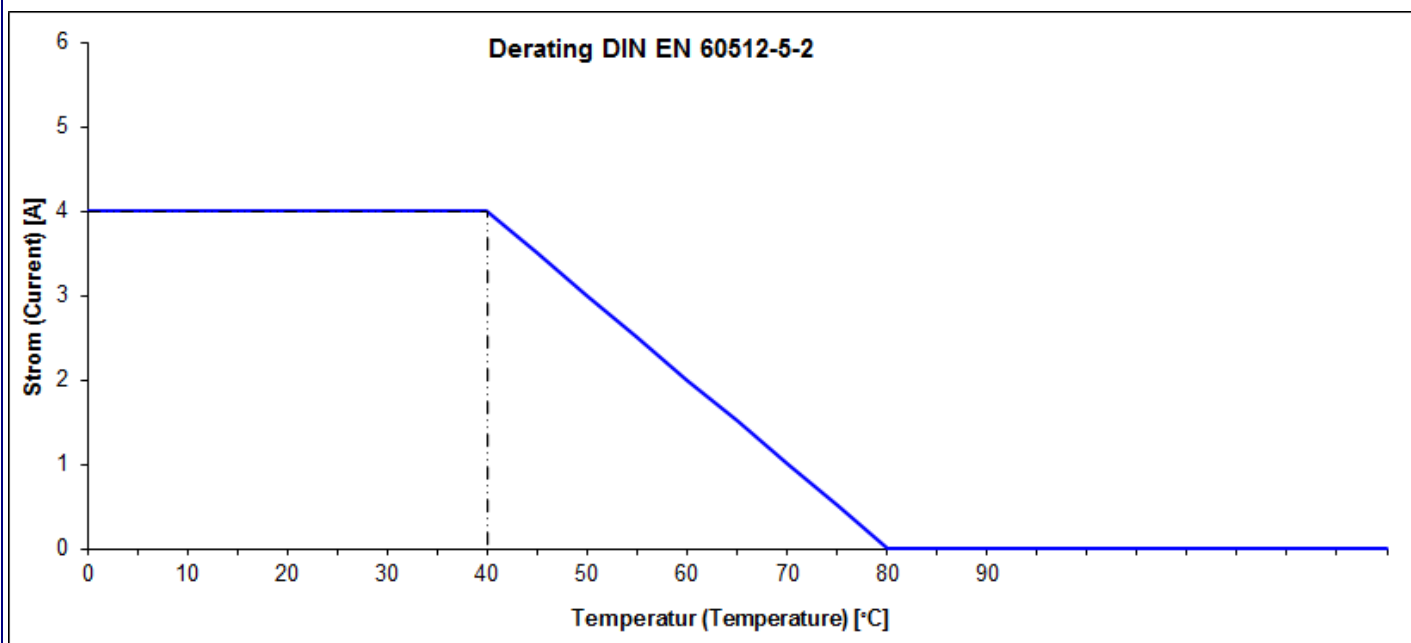

Standard products

Artikel-No.	Type
000-002-520	RST 3-RKMV 3-06/7 M
000-003-711	RST 3-RKMV 3-224/20 M
000-004-369	RST 3-RKMV 3-294/0,5 M
000-017-081	RST 3-RKMV 3-224/1 M
000-017-082	RST 3-RKMV 3-224/2 M
000-028-536	RST 3-RKMV 3-224/0,3 M
000-029-616	RST 3-RKMV 3-224/5 M
000-029-617	RST 3-RKMV 3-224/10 M
000-038-689	RST 3-RKMV 3-224/1,5 M
000-038-690	RST 3-RKMV 3-224/3 M
000-040-190	RST 3-RKMV 3-224/0,6 M
000-043-712	RST 3-RKMV 3-224/3,5 M
000-044-195	RST 3-RKMV 3-224/4 M
000-045-679	RST 3-RKMV 3-224/7 M
000-046-001	RST 3-RKMV 3-264/2 M
000-047-691	RST 3-RKMV 3-06/5 M
000-048-067	RST 3-RKMV 3-06/2 M
000-055-653	RST 3-RKMV 3-264/5 M
000-059-663	RST 3-RKMV 3-280/2 M
000-062-718	RST 3-RKMV 3-224/2,5 M
000-065-137	RST 3-RKMV 3-06/0,3 M
000-065-138	RST 3-RKMV 3-06/0,6 M
000-065-923	RST 3-RKMV 3-264/3 M
000-083-044	RST 3-RKMV 3-264/0,8 M
000-084-043	RST 3-RKMV 3-264/1 M
000-084-547	RST 3-RKMV 3-280/1 M
000-090-829	RST 3-RKMV 3-264/0,5 M
000-092-983	RST 3-RKMV 3-224/15 M
000-096-871	RST 3-RKMV 3-260/0,6 M
000-096-872	RST 3-RKMV 3-260/1 M
000-096-874	RST 3-RKMV 3-260/0,3 M
000-096-876	RST 3-RKMV 3-260/1,5 M
934-636-569	RST 3-RKMV 3-260/2 M
934-637-236	RST 3-RKMV 3-264/0,6 M
934-637-238	RST 3-RKMV 3-264/1,5 M