

RoHS ✓

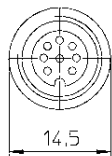
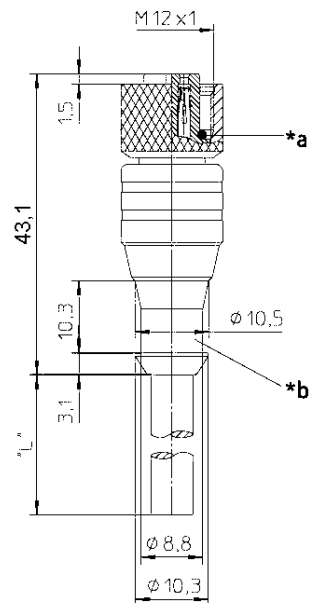

- *a O-Ring
O-ring
- *b Schutzschlauchmontage
hose mounting

Typ/ type	Kontaktbelegung/ contact assignment				
	Polzahl/ number of poles	Farbkennung / color code			
		Variante 01	Variante 02	Variante 03	
RKT 8-6...	8		1 = weiß / white		
			2 = grün / green		
			3 = gelb / yellow		
			4 = grau / gray		
			5 = braun / brown		
			6 = n.c.		
			7 = blau / blue		
			8 = n.c.		
RKT 8-...	8		1 = weiß / white	1 = braun / brown	1 = weiß / white
			2 = braun / brown	2 = weiß / white	2 = braun / brown
			3 = grün / green	3 = blau / blue	3 = grün / green
			4 = gelb / yellow	4 = schwarz / black	4 = gelb / yellow
			5 = grau / gray	5 = grau / gray	5 = grau / gray
			6 = rosa / pink	6 = rosa / pink	6 = rosa / pink
			7 = blau / blue	7 = violett / purple	7 = blau / blue
			8 = Schirm/shield	8 = orange / orange	8 = rot / red

The information/details in this datasheet merely contain general descriptions or performance factors which, when applied in an actual situation, do not always correspond with the described form, and may be amended by way of the further development of products. The desired performance factors shall only be binding if these are expressly agreed on conclusion of the contract.



Product description

- female connector with molded cable and self-locking threaded joint

Type	see standard products
Type of contacts	female
Number of contacts	8, see standard pin assignment page 1
Standard	IEC 61076-2-101
Construction type	LF

Technical data

Clearance / Creepage distance	DIN EN 60664-1 (2008/01); VDE 0110-1
Rated voltage	30 V AC/DC
Rated current *	2 A
Rated impulse voltage	1,5 kVeff./ 60s
Pollution degree	3 acc. to DIN EN 60664-1 (VDE 0110-1)
Contact resistance	≤ 5 mOhm
Insulation resistance	> 10 ⁹ Ohm
Mating cycles	max. 100

* Notice derating

Materials

over molding	TPU
Contact bearer	TPU
Contact	CuZn
Contact plating	Cu/Au
Knurled nut	CuZn, surface nickel-plated
O-ring	FKM

Environmental conditions

Protection class (IEC 60529) *	IP67
Protection class ISO 20653 (DIN 40050-9) *	IP69K
Temperature range (connector)	-25°C to +80°C, notice Derating

Good chemical resistance.

The resistance has to be checked in individual cases.

* only if mounted and locked in combination with Hirschmann / Lumberg connector.

Additional technical data

Fastening torque (coupling nut)	M 12x1: (40-60) Ncm, hand-tight
---------------------------------	---------------------------------

Cutline

Do not connect / disconnect under load.

"L" = standard length of control line (other lengths of control lines on request)

Further technical information on control lines see 909...

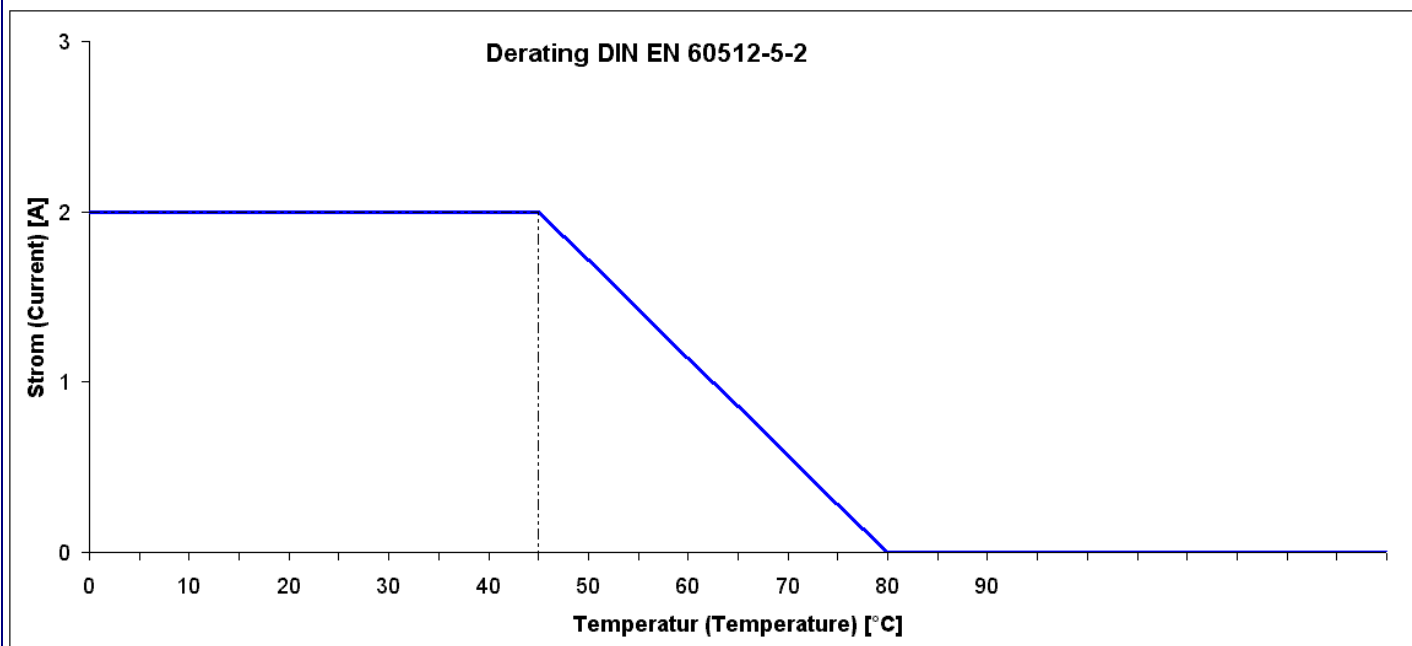

Standard products

Artikel-No.	Type	Pin arrangement
000-000-415	RKT 8-282/45 M	01
000-001-182	RKT 8-505/5 M	03
000-001-184	RKT 8-505/10 M	03
000-002-454	RKT 8-282/3 M	01
000-011-386	RKT 8-09/10 M	01
000-011-387	RKT 8-09/2 M	01
000-011-388	RKT 8-09/5 M	01
000-011-389	RKT 8-6-40/10 M	01
000-011-390	RKT 8-6-40/2 M	01
000-011-391	RKT 8-6-40/5 M	01
000-013-354	RKT 8-09/6 M	01
000-013-355	RKT 8-09/15 M	01
000-013-368	RKT 8-09/10,6 M	01
000-013-369	RKT 8-09/20 M	01
000-015-718	RKT 8-6-268/5 M	01
000-015-727	RKT 8-6-268/10 M	01
000-027-114	RKT 8-09/25 M	01
000-046-772	RKT 8-282/5 M	01
000-046-898	RKT 8-6-268/2 M	01
000-047-077	RKT 8-282/2 M	01
000-055-222	RKT 8-282/15 M	01
000-060-548	RKT 8-282/10 M	01
000-062-977	RKT 8-6-337/2 M	01
000-062-978	RKT 8-6-337/10 M	01
000-062-982	RKT 8-6-337/5 M	01
000-064-115	RKT 8-09/12 M	01
000-076-612	RKT 8-282/20 M	01
000-078-617	RKT 8-282/0,5 M	01
000-080-411	RKT 8-344/10 M	03
000-088-299	RKT 8-362/15 M	02
000-089-741	RKT 8-282/30 M	01
000-097-356	RKT 8-344/2 M	03
000-097-357	RKT 8-344/5 M	03
000-097-616	RKT 8-344/20 M	03
000-098-314	RKT 8-09/8 M	01
000-103-357	RKT 8-09/31 M	01
000-106-747	RKT 8-362/5 M	02
000-106-748	RKT 8-362/10 M	02
000-107-521	RKT 8-299/5 M	03
000-108-560	RKT 8-6-337/15 M	01
000-108-852	RKT 8-09/0,6 M	01
000-108-853	RKT 8-299/3,75 M	03
934-636-021	RKT 8-6-337/20 M	01
934-636-543	RKT 8-6-268/20 M	01
934-637-293	RKT 8-282/8 M	01