

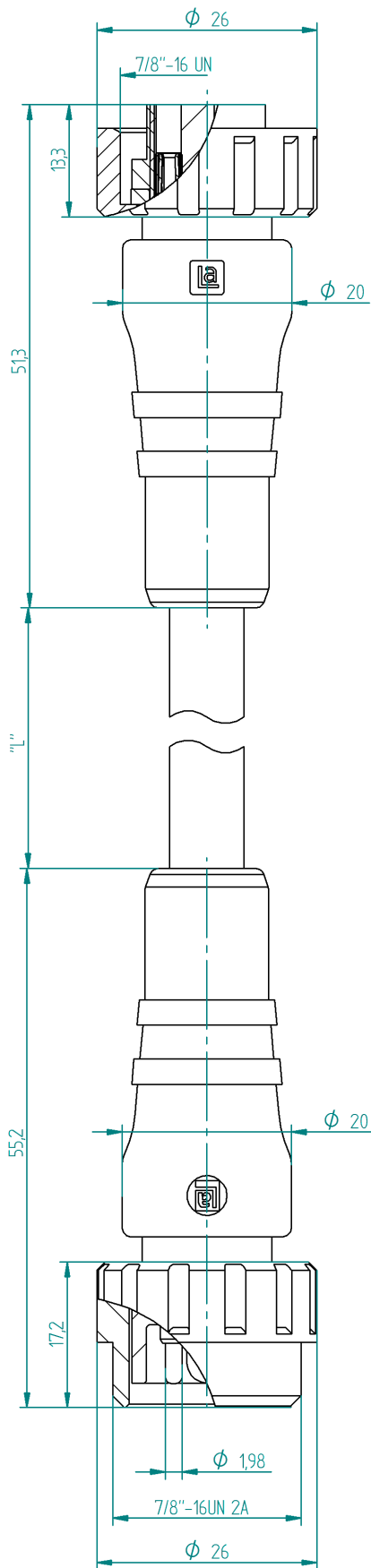

RoHS 



Typ/ type	Kontaktbelegung/ contact assignment	
	Polzahl/ number of poles	Farbkennung/ color code
RS 40		1 = braun / brown 2 = weiß / white
RK 40		3 = blau / blue 4 = schwarz / black
RS 50		1 = schwarz / black 2 = blau / blue 3 = grün-gelb / green-yellow
RK 50		4 = braun / brown 5 = weiß / white

Legende/ cutlinde
"L" Standardlänge der Steuerleitung
 standard length of cable

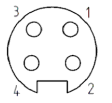
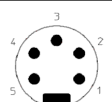
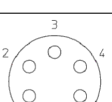
The information/details in this datasheet merely contain general descriptions or performance factors which, when applied in an actual situation, do not always correspond with the described form, and may be amended by way of the further development of products. The desired performance factors shall only be binding if these are expressly agreed on conclusion of the contract.



Product description

Description	7/8" cordset double-ended - 7/8" male and female connector
Type	RSRK...-.../...M, see last page(s)
Order No	see last page(s)
Type of contacts	RS: male RK: female
Number of contacts	see page 1

Technical data

Rated voltage	50 V AC / 75 V DC
Rated current *	9 A
Rated impulse voltage	2,0 kV eff./60s (4 poles) 1,5 kV eff./60s (5 poles)
Pollution degree	3 acc. to DIN EN 60664-1 (VDE 0110-1)
Contact resistance	≤ 5 mΩ
Insulation resistance	> 10 ⁹ Ω

* Notice derating

Materials

over molding	TPU, orange
Contact bearer	TPU, orange
Contact	CuZn
Contact plating	Cu/Au
Coupling screw	PA, black
Coupling nut	PA, black

Environmental conditions

Protection class (IEC 60529) *	IP68 (2h at 10bar)
Temperature range (connector)	-40°C to +90°C **

Good chemical resistance.

The resistance has to be checked in individual cases.

* only if mounted and locked in combination with Hirschmann / Lumberg connector.

** Temperature resistance of the cable considered separately

Cable-data

Cabletype	STL 02,Cable jacket: PVC, outer diameter D= 6,30 mm, conductor cross-section 4x0,50 mm ²
	STL 04,Cable jacket: PVC, outer diameter D= 6,80 mm, conductor cross-section 5x0,50 mm ²

Further types on request

Further technical information on control lines see 909...

Additional technical data

Fastening torque

7/8": 70 Ncm, hand screwed

Cutline

Do not connect / disconnect under load.

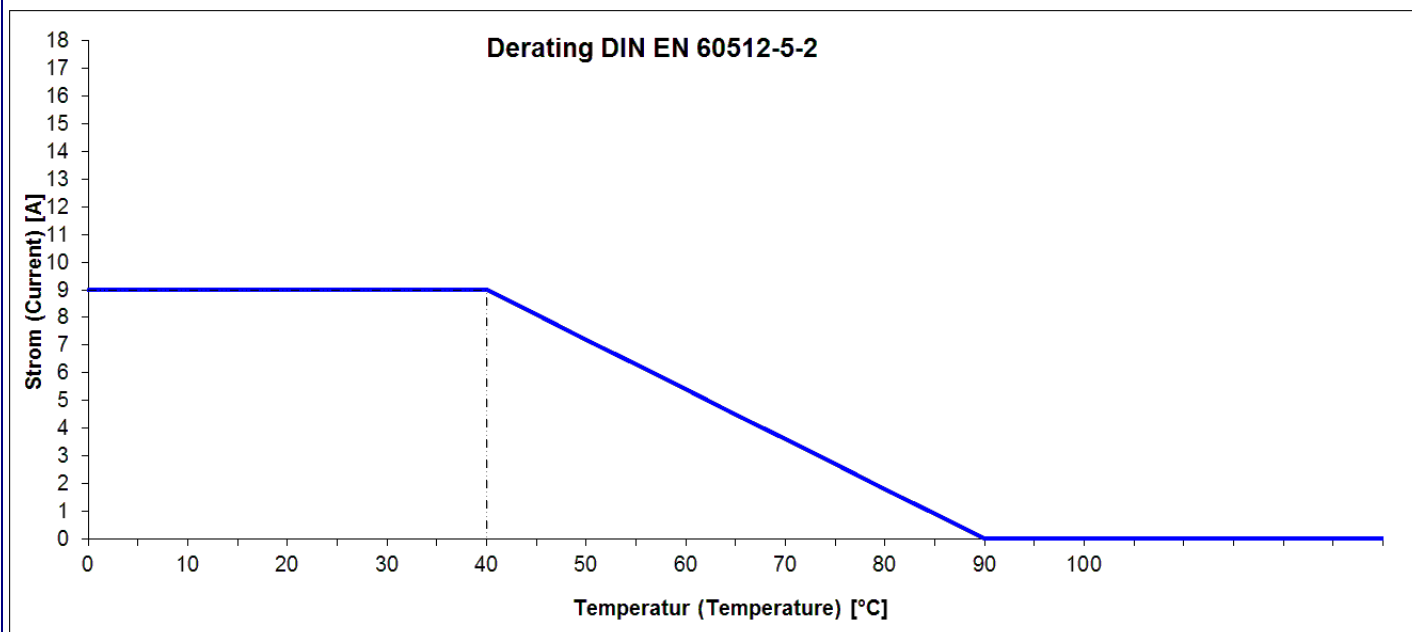

Standard products

Artikel-No.	Type
000-000-200	RSRK 50-04/15 M
000-000-873	RSRK 50-04/7 M
000-009-229	RSRK 40-02/2 M
000-017-172	RSRK 50-04/18 M
000-058-278	RSRK 50-04/5 M
000-108-244	RSRK 50-04/4 M
000-108-248	RSRK 50-04/2 M