



**HIRSCHMANN**

A **BELDEN** BRAND

# User Manual

## Installation

### Industrial Ethernet Rail Switch

### SPIDER Standard Line

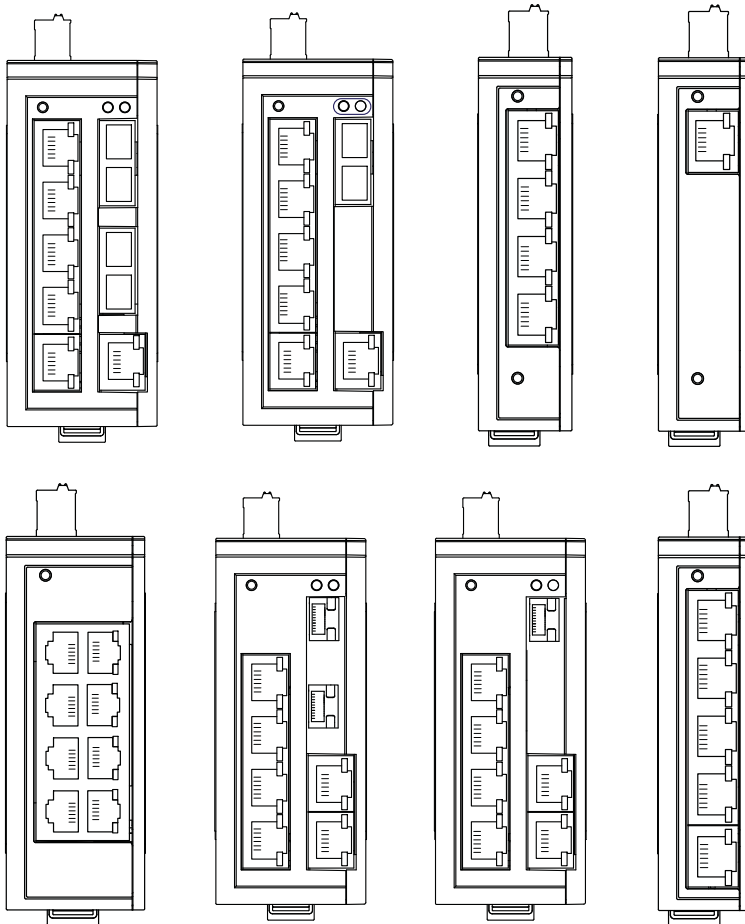

The naming of copyrighted trademarks in this manual, even when not specially indicated, should not be taken to mean that these names may be considered as free in the sense of the trademark and tradename protection law and hence that they may be freely used by anyone.

© 2023 Hirschmann Automation and Control GmbH

Manuals and software are protected by copyright. All rights reserved. The copying, reproduction, translation, conversion into any electronic medium or machine scannable form is not permitted, either in whole or in part. An exception is the preparation of a backup copy of the software for your own use.

The performance features described here are binding only if they have been expressly agreed when the contract was made. This document was produced by Hirschmann Automation and Control GmbH according to the best of the company's knowledge. Hirschmann reserves the right to change the contents of this document without prior notice. Hirschmann can give no guarantee in respect of the correctness or accuracy of the information in this document.

Hirschmann can accept no responsibility for damages, resulting from the use of the network components or the associated operating software. In addition, we refer to the conditions of use specified in the license contract.

You can get the latest version of this manual on the Internet at:  
<https://www.doc.hirschmann.com>

Hirschmann Automation and Control GmbH  
Stuttgarter Str. 45-51  
72654 Neckartenzlingen  
Germany

# Contents

	<b>Important information</b>	<b>5</b>
	<b>Safety instructions</b>	<b>7</b>
	<b>About this Manual</b>	<b>13</b>
	<b>Key</b>	<b>14</b>
<b>1</b>	<b>Description</b>	<b>15</b>
1.1	General device description	15
1.2	Device name and product code	16
1.3	Device view	17
1.3.1	Front view	17
1.4	Power supply	19
1.4.1	Supply voltage with the characteristic value HH	19
1.4.2	Supply voltage with characteristic value HK	19
1.5	Ethernet ports	19
1.5.1	10/100/1000 Mbit/s twisted pair port	20
1.5.2	10/100 Mbit/s twisted pair port	20
1.5.3	100/1000 Mbit/s F/O port	20
1.5.4	100 Mbit/s F/O port	20
1.6	Pin assignments	21
1.7	Display elements	21
1.7.1	Device status	21
1.7.2	Port status	22
<b>2</b>	<b>Installation</b>	<b>23</b>
2.1	Checking the package contents	23
2.2	Mounting the device	23
2.2.1	Installing the device onto the DIN rail	23
2.2.2	Mounting on a flat surface	25
2.3	Installing an SFP transceiver (optional)	25
2.4	Connecting the terminal block	26
2.4.1	Connecting the 3-pin terminal block (device variants with characteristic value HH)	27

2.4.2	Connecting the 3-pin voltage terminal with spring (device variants with the characteristic value HK)	28
2.5	Operating the device	29
2.6	Connecting data cables	29
<b>3</b>	<b>Monitoring the ambient air temperature</b>	<b>30</b>
<b>4</b>	<b>Maintenance and service</b>	<b>31</b>
<b>5</b>	<b>Disassembly</b>	<b>32</b>
5.1	Removing an SFP transceiver (optional)	32
5.2	Removing the device	32
<b>6</b>	<b>Technical data</b>	<b>34</b>
<b>A</b>	<b>Open Source Software used in the product</b>	<b>42</b>
<b>B</b>	<b>Further support</b>	<b>51</b>

# Important information

**Note:** Read these instructions carefully, and familiarize yourself with the device before trying to install, operate, or maintain it. The following notes may appear throughout this documentation or on the device. These notes warn of potential hazards or call attention to information that clarifies or simplifies a procedure.

## ■ Symbol explanation



This is a general warning symbol. This symbol alerts you to potential personal injury hazards. Observe all safety notes that follow this symbol to avoid possible injury or death.



If this symbol is displayed in addition to a safety instruction of the type “Danger” or “Warning”, it means that there is a danger of electric shock and failure to observe the instructions will inevitably result in injury.



This symbol indicates the danger of hot surfaces on the device. In connection with safety instructions, non-observance of the instructions will inevitably result in injuries.



## **DANGER**

**DANGER** draws attention to an immediately dangerous situation, which will **inevitably** result in a serious or fatal accident if not observed.



## **WARNING**

**WARNING** indicates a potentially hazardous situation which, if not avoided, **could** result in death or serious injury.



## **CAUTION**

**CAUTION** indicates a possible danger which, if not avoided, **may** result in minor injuries.

# NOTICE

**NOTICE** provides information about procedures that do not involve the risk of injury.

# Safety instructions

## ■ General safety instructions

You operate this device with electricity. Improper usage of the device entails the risk of physical injury or significant property damage. The proper and safe operation of this device depends on proper handling during transportation, proper storage and installation, and careful operation and maintenance procedures.

- ☐ Before connecting any cable, read this document, and the safety instructions and warnings.
- ☐ Operate the device with undamaged components exclusively.
- ☐ The device is free of any service components. In case of a damaged or malfunctioning device, turn off the supply voltage and return the device to Hirschmann for inspection.

## ■ Certified usage

- ☐ Use the product only for the application cases described in the Hirschmann product information, including this manual.
- ☐ Operate the product only according to the technical specifications. [See “Technical data” on page 34.](#)
- ☐ Connect to the product only components suitable for the requirements of the specific application case.

## ■ Installation site requirements

- ☐ Operate the device only at the specified ambient temperature (temperature of the ambient air at a distance of 5 cm (2 in) from the device) and at the specified relative humidity.
- ☐ When you are selecting the installation location, make sure you observe the climatic threshold values specified in the technical data.
- ☐ Use the device in an environment with a maximum pollution degree that complies with the specifications in the technical data.
- ☐ Install the device in a switch cabinet or on a wall.

## ■ Strain relief

**Note:** If the strain relief is insufficient, there is a potential risk of torsion, contact problems and creeping interruptions.

- ☐ Relieve the connection points of cables and lines from mechanical stress.
- ☐ Design strain reliefs in such a way that they help prevent any mechanical damage to cables, wires or conductors caused by external influences or their own weight.
- ☐ To help prevent damage to device connections, connectors and cables, follow the instructions for proper installation in accordance with DIN VDE 0100-520:2013-06, sections 522.6, 522.7 and 522.13.

## ■ Device casing

Only technicians authorized by the manufacturer are permitted to open the casing.

- ☐ Never insert pointed objects (narrow screwdrivers, wires, etc.) into the device or into the connection terminals for electric conductors. Do not touch the connection terminals.
- ☐ Keep the ventilation slits free to ensure good air circulation.  
[See “General technical data” on page 34.](#)
- ☐ Mount the device in the vertical position.

## ■ Qualification requirements for personnel

- ☐ Only allow qualified personnel to work on the device.

Qualified personnel have the following characteristics:

- ▶ Qualified personnel are properly trained. Training as well as practical knowledge and experience make up their qualifications. This is the prerequisite for grounding and labeling circuits, devices, and systems in accordance with current standards in safety technology.
- ▶ Qualified personnel are aware of the dangers that exist in their work.
- ▶ Qualified personnel are familiar with appropriate measures against these hazards in order to reduce the risk for themselves and others.
- ▶ Qualified personnel receive training on a regular basis.

## ■ National and international safety regulations

Verify that the electrical installation meets local or nationally applicable safety regulations.

## ■ Grounding the device

The device is grounded by a 3-pin terminal block.

- ☐ Use a wire diameter for the ground conductor that is no smaller than the diameter of the supply voltage connection, however of at least 0.5 mm<sup>2</sup> (20 AWG).



## ■ Shielding ground

The shielding ground of the connectable twisted pair cables is connected to the ground connection as a conductor.

- Beware of possible short circuits when connecting a cable section with conductive shielding braiding.

## ■ Requirements for connecting electrical wires

Before connecting the electrical wires, **always** verify that the requirements listed are complied with.

### General requirements for connecting electrical wires

The following requirements apply without restrictions:

- ▶ The electrical wires are voltage-free.
- ▶ The cables used are permitted for the temperature range of the application case.
- ▶ The switched voltage complies with the requirements for a safety extra-low voltage (SELV) according to IEC 60950-1 or ES1 according to IEC/EN 62368-1.
- ▶ Relevant for North America:  
Exclusively use 60/75 °C (140/167 °F) or 75 °C (167 °F) copper (Cu) wire.

### Requirements for connecting the supply voltage

The following requirements apply without restrictions:

- ▶ The supply voltage corresponds to the voltage specified on the type plate of the device.
- ▶ The power supply conforms to overvoltage category I or II.
- ▶ The power supply has an easily accessible disconnecting device (for example a switch or a plug). This disconnecting device is clearly identified. So in the case of an emergency, it is clear which disconnecting device belongs to which power supply cable.
- ▶ The power supply cable is suitable for the voltage, the current and the physical load. Hirschmann recommends a wire diameter of 0.5 mm<sup>2</sup> (20 AWG).
- ▶ The cross-section of the ground conductor is the same size as or bigger than the cross-section of the power supply cables.

The following requirements apply alternatively:

- |               |   |
|---------------|---|
| Alternative 1 | The power supply complies with the requirements for a limited power source (LPS) according to IEC 60950-1 or ES1 + PS2 according to IEC/EN 62368-1.   |
| Alternative 2 | <b>All</b> of the following requirements are complied with: <ul style="list-style-type: none"><li>▶ The power supply complies with the requirements for a safety extra-low voltage (SELV) according to IEC 60950-1 or ES1 according to IEC/EN 62368-1.</li><li>▶ A back-up fuse suitable for DC voltage is located in the plus conductor of the power supply.<br/>The minus conductor is on ground potential. Otherwise, a back-up fuse is also located in the minus conductor.<br/>Regarding the properties of this back-up fuse:<br/><a href="#">See "General technical data" on page 34.</a></li></ul> |
| Alternative 3 | Relevant for North America:<br>The power supply complies with the requirements according to NEC Class 2.  |

## ■ Supply voltage

The supply voltage is only connected with the ground connection via protective elements.

## ■ **CE marking**

The labeled devices comply with the regulations contained in the following European directive(s):

### **2011/65/EU and 2015/863/EU (RoHS)**

Directive of the European Parliament and of the Council on the restriction of the use of certain hazardous substances in electrical and electronic equipment.

### **2014/30/EU (EMC)**

Directive of the European Parliament and of the Council on the harmonisation of the laws of the Member States relating to electromagnetic compatibility.

In accordance with the above-named EU directive(s), the EU conformity declaration will be available to the relevant authorities at the following address:

Hirschmann Automation and Control GmbH  
Stuttgarter Str. 45-51  
72654 Neckartenzlingen  
Germany

You find the EU conformity declaration as PDF file for downloading on the Internet at: <https://www.doc.hirschmann.com/certificates.html>

The device can be used in industrial environments.

► Interference immunity: EN 61000-6-2

► Emitted interference: EN 55032

You find more information on technical standards here:

[“Technical data” on page 34](#)

**Warning!** This is a class A device. This device can cause interference in living areas, and in this case the operator may be required to take appropriate measures.

**Note:** The assembly guidelines provided in these instructions must be strictly adhered to in order to observe the EMC threshold values.

## ■ **UKCA marking**

The labeled devices comply with the following UK regulations:

### **S.I. 2012 No. 3032**

Restriction of the Use of Certain Hazardous Substances in Electrical and Electronical Equipment Regulations

### **S.I. 2016 No. 1091**

Electromagnetic Compatibility Regulations 2016



The UKCA conformity declaration will be available to the relevant authorities at the following address:

Belden UK Ltd.  
1 The Technology Centre, Station Road  
Framlingham, IP13 9EZ, United Kingdom

You find the UKCA conformity declaration as PDF file for downloading on the Internet at: <https://www.doc.hirschmann.com/certificates.html>

The device can be used in industrial environments.

- ▶ Interference immunity: EN 61000-6-2
- ▶ Emitted interference: EN 55032

You find more information on technical standards here:

[“Technical data” on page 34](#)

**Warning!** This is a class A device. This device can cause interference in living areas, and in this case the operator may be required to take appropriate measures.

**Note:** The assembly guidelines provided in these instructions must be strictly adhered to in order to observe the EMC threshold values.

#### ■ **LED or laser components**

LED or LASER components according to IEC 60825-1 (2014):

CLASS 1 LASER PRODUCT

CLASS 1 LED PRODUCT

## ■ FCC note

### Supplier's Declaration of Conformity 47 CFR § 2.1077 Compliance Information

SPIDER-SL

#### U.S. Contact Information

Belden – St. Louis  
1 N. Brentwood Blvd. 15th Floor  
St. Louis, Missouri 63105, United States  
Phone: 314.854.8000

This device complies with part 15 of the FCC Rules. Operation is subject to the following two conditions: (1) This device may not cause harmful interference, and (2) this device must accept any interference received, including interference that may cause undesired operation.

**Note:** This equipment has been tested and found to comply with the limits for a Class A digital device, pursuant to part 15 of the FCC Rules. These limits are designed to provide reasonable protection against harmful interference when the equipment is operated in a commercial environment. This equipment generates, uses, and can radiate radio frequency energy and, if not installed and used in accordance with the instruction manual, may cause harmful interference to radio communications. Operation of this equipment in a residential area is likely to cause harmful interference in which case the user will be required to correct the interference at his own expense.

## ■ Recycling note



The symbol of a crossed-out wheeled bin shown on the device indicates that the device **MUST NOT** be disposed of with household waste at the end of its service life.

After its service life, the used device must be disposed of properly as electronic waste in accordance with the locally applicable disposal regulations.

End users are responsible for deleting personal data from the used device prior to disposal.

End users are obliged to separate used batteries and accumulators that are not enclosed by the used device from the used device in a non-destructive manner before disposing of the used device. The used batteries and accumulators must be handed in for separate collection. This does not apply if the used device is handed in for reuse.

# About this Manual

The “Installation” user manual contains a device description, safety instructions, a description of the display, and the other information that you need to install the device.

Documentation mentioned in the “User Manual Installation” that is not supplied with your device as a printout can be found as PDF files for downloading on the Internet at: <https://www.doc.hirschmann.com>

# Key

The symbols used in this manual have the following meanings:

▶	Listing
□	Work step
■	Subheading

# 1 Description

## 1.1 General device description

The device is designed for the special requirements of industrial automation. The device meets the relevant industry standards, provides very high operational reliability, even under extreme conditions, and also long-term reliability and flexibility.

You have numerous options of combining the device characteristics. You can determine the possible combinations using the configurator which is available in the Belden Online Catalog <https://catalog.belden.com> on the web page of the device.

## 1.2 Device name and product code

The device name corresponds to the product code. The product code is made up of characteristics with defined positions. The characteristic values stand for specific product properties.

The following device variants have a corresponding short designation in addition to the product code:

Short designation	Product code
SSR40-5TX	SPIDER-SL-40-05T1999999SxxxxHHxx
SSR40-6TX/2SFP	SPIDER-SL-40-06T1O6O699SxxxxHHxx
SSR40-8TX	SPIDER-SL-40-08T1999999SxxxxHHxx

Table 1: Device variants with short designation

Item	Characteristic	Characteristic value	Description
1 ... 9	Product	SPIDER-SL	SPIDER Standard Line
10	(hyphen)	–	
11	Data rate	2	10/100 Mbit/s
		4	10/100/1000 Mbit/s
12	Power over Ethernet (PoE)	0	without PoE support
13	(hyphen)	–	
14 ... 17	Number Twisted pair ports	01T1	
		04T1	
		05T1	
		06T1	
		08T1	
18 ... 19	Optical fiber port 1	M2	DSC multimode socket for 100 Mbit/s F/O connections
		S2	DSC singlemode socket for 100 Mbit/s F/O connections
		M4	ST multimode socket for 100 Mbit/s F/O connections
		O6	SFP slot for 100/1000 Mbit/s F/O connections
		99	without
20 ... 21	Optical fiber port 2	M2	DSC multimode socket for 100 Mbit/s F/O connections
		S2	DSC singlemode socket for 100 Mbit/s F/O connections
		O6	SFP slot for 100/1000 Mbit/s F/O connections
		99	without
22 ... 23	Optical fiber port 3	99	without

Table 2: Device name and product code



Item	Characteristic	Characteristic value	Description	
24	Temperature range	S	Standard	0 °C ... +60 °C (+32 °F ... +140 °F) Derating <sup>a</sup>
		T	Extended	-40 °C ... +70 °C (-40 °F ... +158 °F)
25 ... 26	Certificates and declarations	Z9	CE, FCC, EN 61131, RCM	
		Y9	Z9 + cUL 61010	
		TY	Y9 + EN 50121-4	
27 ... 28	Customer-specific version	HH	Hirschmann Standard	
		HK	Voltage terminal with spring	
29 ... 30	Configuration	HH	Hirschmann Standard	

**Table 2:** Device name and product code

- a. For device variants SPIDER SL-40-06T1O6O699SZ9HHHH and SSR40-6TX/2SFP, the maximum permitted ambient air temperature has to be reduced to +50 °C (+122 °F).

## 1.3 Device view

### 1.3.1 Front view

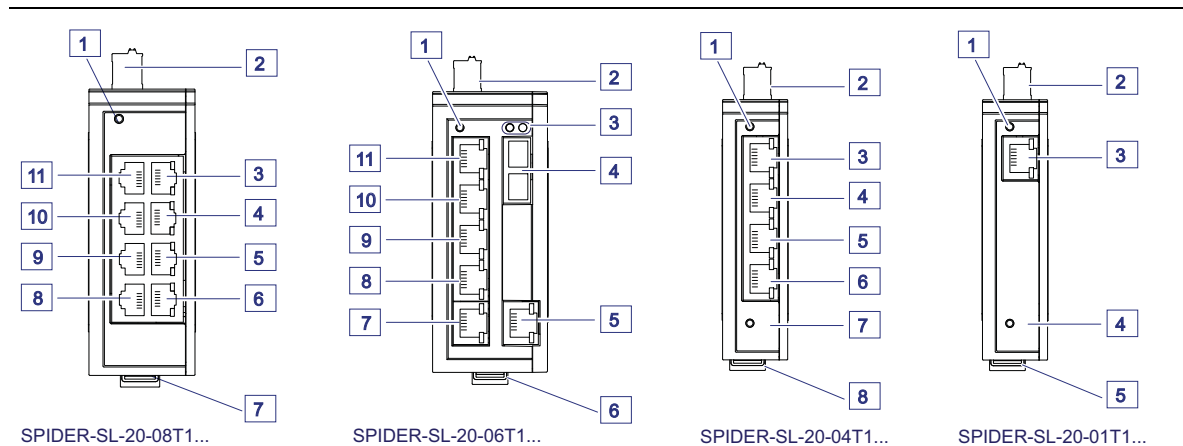

Front view using example of device variants SPIDER-SL-20...

#### SPIDER-SL-20-08T1...

- |          |  |
|----------|--|
| 1        | LED display elements for device status                     |
| 2        | 3-pin, pluggable terminal block for power supply           |
| 3 ... 6  | 4 × RJ45 socket for 10/100 Mbit/s Twisted pair connections |
| 7        | Rail lock slide for DIN rail mounting                      |
| 8 ... 11 | 4 × RJ45 socket for 10/100 Mbit/s Twisted pair connections |

#### SPIDER-SL-20-06T1...

- |   |  |
|---|--|
| 1 | LED display elements for device status           |
| 2 | 3-pin, pluggable terminal block for power supply |
| 3 | LED display elements for port status             |

4	depending on device variant
	► DSC multimode socket for 100 Mbit/s F/O connections
	► DSC singlemode socket for 100 Mbit/s F/O connections
5	RJ45 socket for 10/100 Mbit/s Twisted pair connections
6	Rail lock slide for DIN rail mounting
7 ... 11	5 × RJ45 socket for 10/100 Mbit/s Twisted pair connections
<b>SPIDER-SL-20-04T1...</b>	
1	LED display elements for device status
2	3-pin, pluggable terminal block for power supply
3 ... 6	4 × RJ45 socket for 10/100 Mbit/s Twisted pair connections
7	LED display elements for port status
8	Rail lock slide for DIN rail mounting
<b>SPIDER-SL-20-01T1...</b>	
1	LED display elements for device status
2	3-pin, pluggable terminal block for power supply
3	RJ45 socket for 10/100 Mbit/s Twisted pair connections
4	LED display elements for port status
5	Rail lock slide for DIN rail mounting

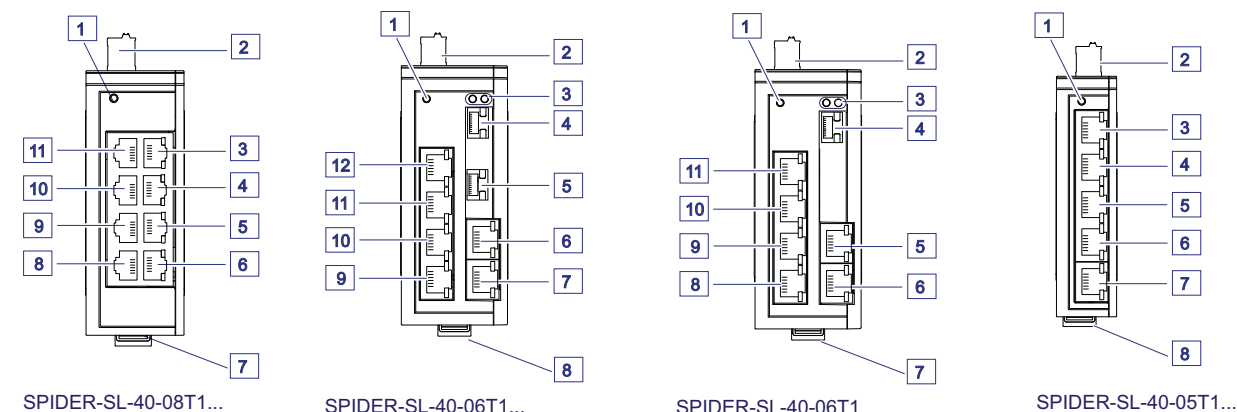

Front view using example of device variants SPIDER-SL-40...

<b>SPIDER-SL-40-08T1...</b>	
1	LED display elements for device status
2	3-pin, pluggable terminal block for power supply
3 ... 6	4 × RJ45 socket for 10/100/1000 Mbit/s Twisted Pair connections
7	Rail lock slide for DIN rail mounting
8 ... 11	4 × RJ45 socket for 10/100/1000 Mbit/s Twisted Pair connections
<b>SPIDER-SL-40-06T1...</b>	
1	LED display elements for device status
2	3-pin, pluggable terminal block for power supply
3	LED display elements for port status
4 ... 5	SFP slot for 100/1000 Mbit/s F/O connections
6 ... 7	2 × RJ45 socket for 10/100/1000 Mbit/s Twisted Pair connections
8	Rail lock slide for DIN rail mounting
9 ... 12	4 × RJ45 socket for 10/100/1000 Mbit/s Twisted Pair connections
<b>SPIDER-SL-40-06T1...</b>	
1	LED display elements for device status
2	3-pin, pluggable terminal block for power supply

3	LED display elements for port status
4	SFP slot for 100/1000 Mbit/s F/O connections
5 ... 6	2 × RJ45 socket for 10/100/1000 Mbit/s Twisted Pair connections
7	Rail lock slide for DIN rail mounting
8 ... 11	4 × RJ45 socket for 10/100/1000 Mbit/s Twisted Pair connections
<b>SPIDER-SL-40-05T1...</b>	
1	LED display elements for device status
2	3-pin, pluggable terminal block for power supply
3 ... 7	5 × RJ45 socket for 10/100/1000 Mbit/s Twisted Pair connections
8	Rail lock slide for DIN rail mounting

## 1.4 Power supply

### 1.4.1 Supply voltage with the characteristic value HH

The following options for power supply are available:

- 3-pin terminal block

You will find information on connecting the supply voltage here:

[See “Connecting the 3-pin terminal block \(device variants with characteristic value HH\)” on page 27.](#)

### 1.4.2 Supply voltage with characteristic value HK

The following options for power supply are available:

- 3-pin terminal block

You will find information on connecting the supply voltage here:

[See “Connecting the 3-pin voltage terminal with spring \(device variants with the characteristic value HK\)” on page 28.](#)

## 1.5 Ethernet ports

You can connect end devices and other segments to the device ports using twisted pair cables or optical fibers (F/O).

You find information on the pin assignments for making patch cables here: [“Pin assignments” on page 21](#)

### **1.5.1 10/100/1000 Mbit/s twisted pair port**

This port is an RJ45 socket.

The 10/100/1000 Mbit/s twisted pair port allows you to connect network components according to the IEEE 802.3 10BASE-T/100BASE-TX/1000BASE-T standard.

This port supports:

- ▶ Autonegotiation
- ▶ Autopolarity
- ▶ Autocrossing
- ▶ 1000 Mbit/s full duplex
- ▶ 100 Mbit/s half-duplex mode, 100 Mbit/s full duplex mode
- ▶ 10 Mbit/s half-duplex mode, 10 Mbit/s full duplex mode

### **1.5.2 10/100 Mbit/s twisted pair port**

This port is an RJ45 socket.

The 10/100 Mbit/s twisted pair port allows you to connect network components according to the IEEE 802.3 10BASE-T/100BASE-TX standard.

This port supports:

- ▶ Autonegotiation
- ▶ Autopolarity
- ▶ Autocrossing
- ▶ 100 Mbit/s half-duplex mode, 100 Mbit/s full duplex mode
- ▶ 10 Mbit/s half-duplex mode, 10 Mbit/s full duplex mode

### **1.5.3 100/1000 Mbit/s F/O port**

This port is an SFP slot.

The 100/1000 Mbit/s F/O port allows you to connect network components according to the IEEE 802.3 100BASE-FX/1000BASE-SX/1000BASE-LX standard.

This port supports:

- ▶ 100 Mbit/s full duplex when using a Fast Ethernet SFP transceiver
- ▶ 1000 Mbit/s full duplex when using a Gigabit Ethernet SFP transceiver

### **1.5.4 100 Mbit/s F/O port**

The 100 Mbit/s F/O port allows you to connect network components according to the IEEE 802.3 100BASE-FX standard.

This port supports:

- ▶ Full duplex mode

## 1.6 Pin assignments

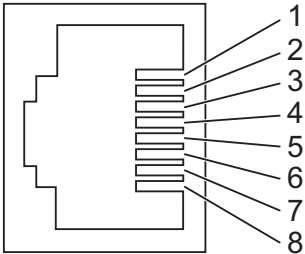
RJ45	Pin	10/100 Mbit/s	1000 Mbit/s
	<b>MDI mode</b>		
	1	TX+	BI_DA+
	2	TX-	BI_DA-
	3	RX+	BI_DB+
	4	—	BI_DC+
	5	—	BI_DC-
	6	RX-	BI_DB-
	7	—	BI_DD+
	8	—	BI_DD-
	<b>MDI-X mode</b>		
	1	RX+	BI_DB+
	2	RX-	BI_DB-
	3	TX+	BI_DA+
	4	—	BI_DD+
	5	—	BI_DD-
	6	TX-	BI_DA-
	7	—	BI_DC+
	8	—	BI_DC-

## 1.7 Display elements

After the supply voltage is switched on, the device performs a self-test. During this process, various LEDs light up.

### 1.7.1 Device status

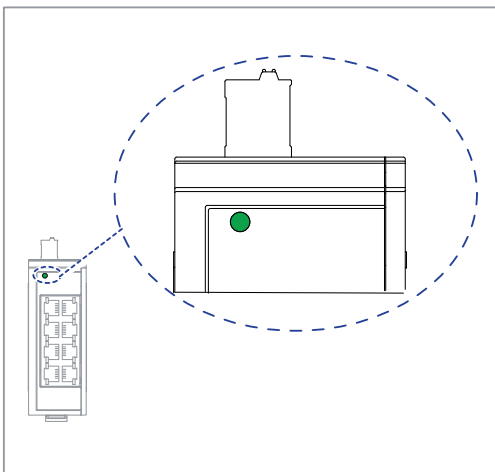

This LED provides information on the status of the power supply.

Color	Activity	Meaning
green	lights up	Supply voltage is on Device is ready for operation
	none	Supply voltage is too low Device is not ready for operation

## 1.7.2 Port status

These LEDs provide port-related information.

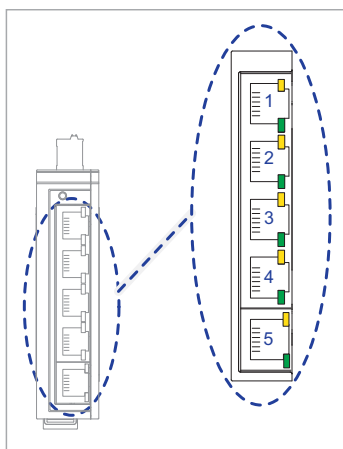

L/D (link status/data)	Color	Activity	Meaning
	green	lights up	Device detects a valid link
	green	flashing	Device is transmitting and/or receiving data
	–	none	Device detects an invalid or missing link

The display element for the data rate depends on the device variant used.  
The following display options are possible:

LED display element	Color	Activity	Meaning
SP (data rate)	yellow	flashes 1 × a period	10 Mbit/s connection
	yellow	flashes 2 × a period	100 Mbit/s connection
	yellow	flashes 3 × a period	1000 Mbit/s connection
	–	none	no additional information
100 Mbit/s	yellow	flashes	100 Mbit/s connection
	–	none	no 100 Mbit/s connection
without	–	–	–

## 2 Installation

The devices have been developed for practical application in a harsh industrial environment.

On delivery, the device is ready for operation.

To install the device, perform the following work steps:

- ▶ [Checking the package contents](#)
- ▶ [Mounting the device](#)
- ▶ [Installing an SFP transceiver \(optional\)](#)
- ▶ [Connecting the terminal block](#)
- ▶ [Operating the device](#)
- ▶ [Connecting data cables](#)

### 2.1 Checking the package contents

- ☐ Check whether the package includes all items named in the section [“Scope of delivery” on page 38](#).
- ☐ Check the individual parts for transport damage.

### 2.2 Mounting the device

You have the following options for mounting your device:

- ▶ [Installing the device onto the DIN rail](#)
- ▶ [Mounting on a flat surface](#)

#### 2.2.1 Installing the device onto the DIN rail

Prerequisite:

The device is for mounting on a 35 mm DIN rail in accordance with DIN EN 60715.

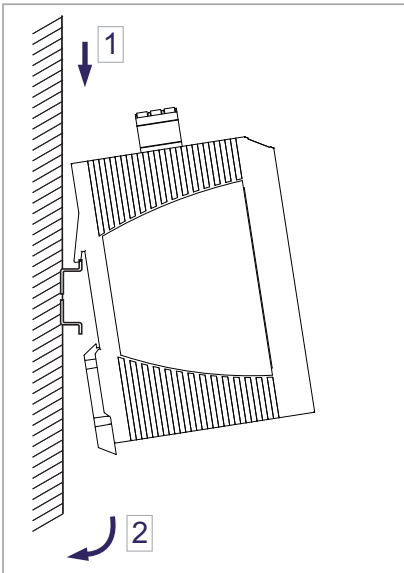

Perform the following work steps:

- ☐ Slide the upper snap-in guide of the device into the DIN rail.
- ☐ Use a screwdriver to pull the rail lock slide downwards.
- ☐ Snap in the device by releasing the rail lock slide.



## 2.2.2 Mounting on a flat surface

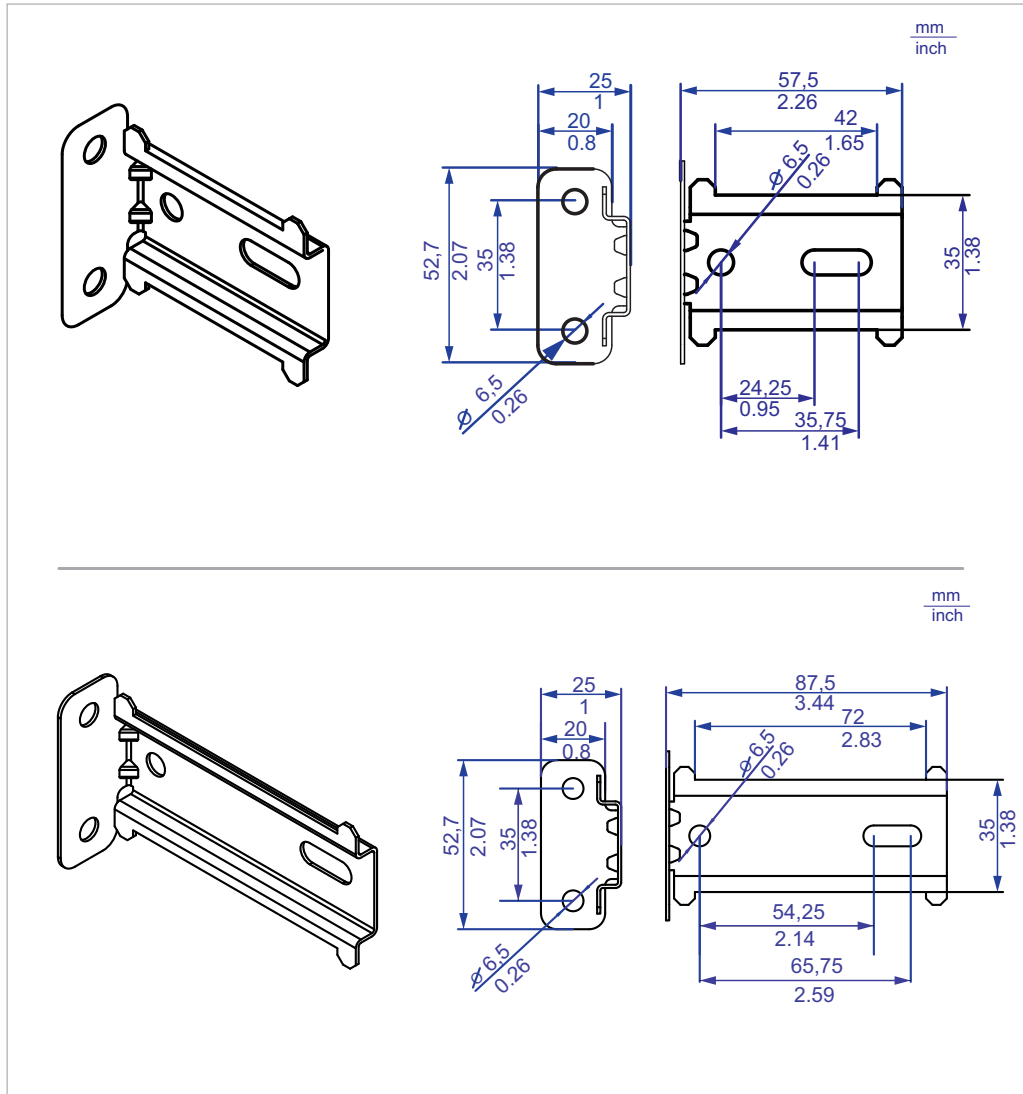

Perform the following work steps:

- ☐ Attach the wall mounting plate to a flat surface of the wall using screws. You will find the dimensions necessary for mounting the device in the illustration.
- ☐ Mount the device on the wall mounting plate. Insert the upper snap-in guide of the device into the rail and press it down against the rail until it snaps into place.
- Two models of wall mounting plates are available.  
[See "Accessories" on page 39.](#)

## 2.3 Installing an SFP transceiver (optional)

**Prerequisites:**

Exclusively use Hirschmann SFP transceivers.  
See “Accessories” on page 39.

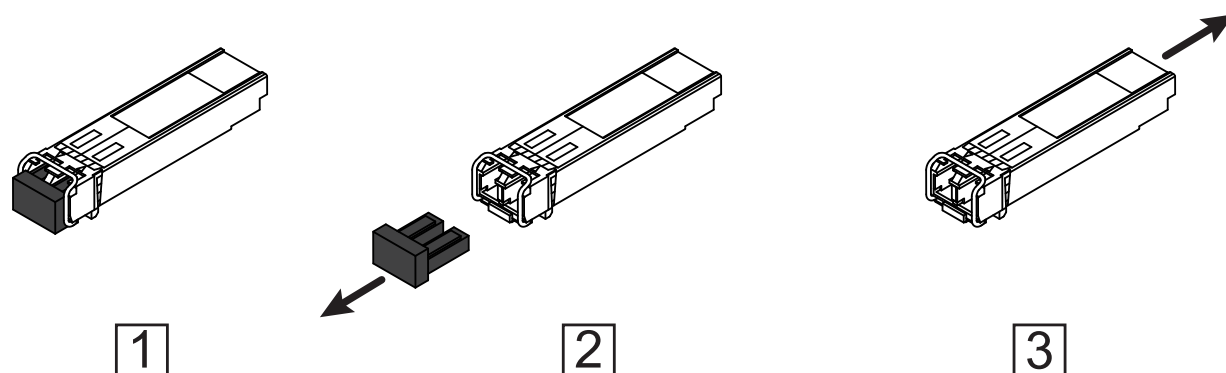

Figure 1: Installing SFP transceivers: Installation sequence

**Perform the following work steps:**

- ☐ Take the SFP transceiver out of the transport packaging (1).
- ☐ Remove the protection cap from the SFP transceiver (2).
- ☐ Push the SFP transceiver with the lock closed into the slot until it latches in (3).

## 2.4 Connecting the terminal block



### WARNING

#### ELECTRIC SHOCK

Exclusively connect a supply voltage that corresponds to the type plate of your device.

Never insert sharp objects (small screwdrivers, wires, etc.) into the connection terminals for the supply voltage, and do not touch the terminals.

**Failure to follow this instruction can result in death, serious injury, or equipment damage.**

A 3-pin terminal block is used for the grounding and for connecting the supply voltage.

The supply voltage is only connected with the ground connection via protective elements.

The shielding ground of the connectable twisted pair cables is connected to the ground connection as a conductor.

**2.4.1 Connecting the 3-pin terminal block (device variants with characteristic value HH)**

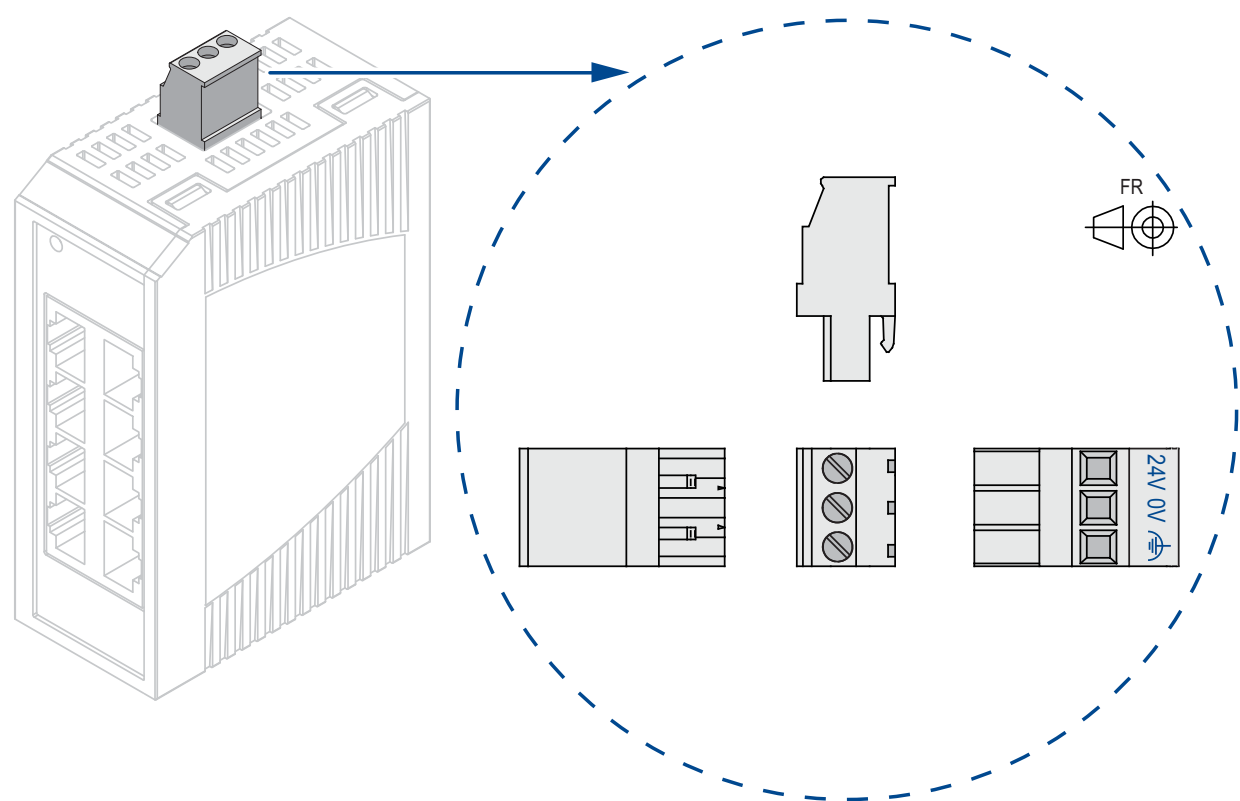

Figure 2: 3-pin terminal block, characteristic value HH

Type of the voltages that can be connected	Specification of the supply voltage	Pin assignment
DC voltage	Rated voltage range 12 V DC ... 24 V DC Voltage range incl. maximum tolerances 9.6 V DC ... 32 V DC	24 V DC Plus terminal of the supply voltage
		0 V Minus terminal of the supply voltage
		 Functional ground connection

Table 3: Type and specification of the supply voltage and pin assignment on the device

**Perform the following work steps:**

- ☐ Verify the required conditions for connecting the voltage supply.  
[See “Requirements for connecting electrical wires” on page 9.](#)
- ☐ Remove the terminal connector from the device.
- ☐ Connect the wires according to the pin assignment on the device with the clamps.
- ☐ Fasten the wires in the terminal block by tightening the terminal screws.
- ☐ Mount the terminal block for the supply voltage and the ground by plugging them in.

2.4.2 Connecting the 3-pin voltage terminal with spring (device variants with the characteristic value HK)

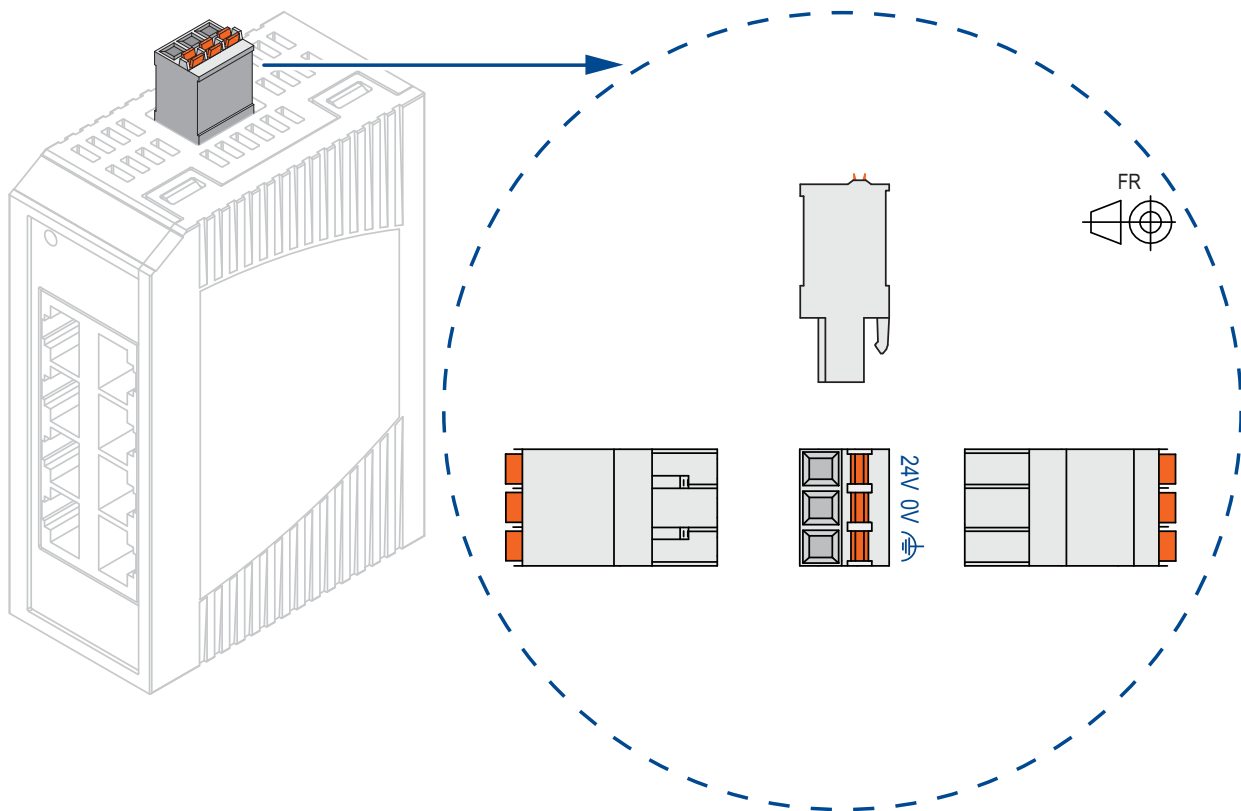

Figure 3: 3-pin voltage terminal with spring, characteristic value HK

Type of the voltages that can be connected	Specification of the supply voltage	Pin assignment
DC voltage	Rated voltage range 12 V DC ... 24 V DC	24 V DC Plus terminal of the supply voltage
	Voltage range incl. maximum tolerances 9.6 V DC ... 32 V DC	0 V Minus terminal of the supply voltage
		Functional ground connection

Table 4: Type and specification of the supply voltage and pin assignment on the device

Perform the following work steps:

- ☐ Verify the required conditions for connecting the voltage supply.  
[See “Requirements for connecting electrical wires” on page 9.](#)
- ☐ Remove the terminal connector from the device.
- ☐ Open the terminal lock by pressing the corresponding lever with a screwdriver.

- ☐ Connect the wires according to the pin assignment on the device with the clamps.
- ☐ Mount the terminal block for the supply voltage and the ground by plugging them in.

## **2.5      Operating the device**

By connecting the supply voltage via the terminal block, you start the operation of the device.

## **2.6      Connecting data cables**

Note the following general recommendations for data cable connections in environments with high electrical interference levels:

- ☐ Keep the length of the data cables as short as possible.
- ☐ The use of electrical data cables is restricted to applications inside buildings.
- ☐ Use optical data cables for the data transmission between the buildings.
- ☐ When using copper cables, provide a sufficient separation between the power supply cables and the data cables. Ideally, install the cables in separate cable channels.
- ☐ Verify that power supply cables and data cables do not run parallel over longer distances. To reduce inductive coupling, verify that the power supply cables and data cables cross at a 90 ° angle.
- ☐ Use shielded data cables for gigabit transmission via copper cables, for example SF/UTP cables according to ISO/IEC 11801. To meet EN 50121-4 and marine application requirements, use shielded data cables at all transmission rates.
- ☐ Connect the data cables according to your requirements.

[See “Ethernet ports” on page 19.](#)

### **3 Monitoring the ambient air temperature**

Operate the device below the specified maximum ambient air temperature exclusively.

[See “General technical data” on page 34.](#)

The ambient air temperature is the temperature of the air at a distance of 5 cm (2 in) from the device. It depends on the installation conditions of the device, for example the distance from other devices or other objects, and the output of neighboring devices.

## 4 Maintenance and service

When designing this device, Hirschmann largely avoided using high-wear parts. The parts subject to wear and tear are dimensioned to last longer than the lifetime of the product when it is operated normally. Operate this device according to the specifications.

Depending on the degree of pollution in the operating environment, check at regular intervals that the ventilation slots in the device are not obstructed.



### CAUTION

#### RISK OF TRANSIENTS OR ELECTROSTATIC DISCHARGES

Do not open the housing.

**Failure to follow these instructions can result in injury or equipment damage.**

**Note:** You find information on settling complaints on the Internet at <http://www.beldensolutions.com/en/Service/Repairs/index.phtml>.

## 5 Disassembly

### 5.1 Removing an SFP transceiver (optional)

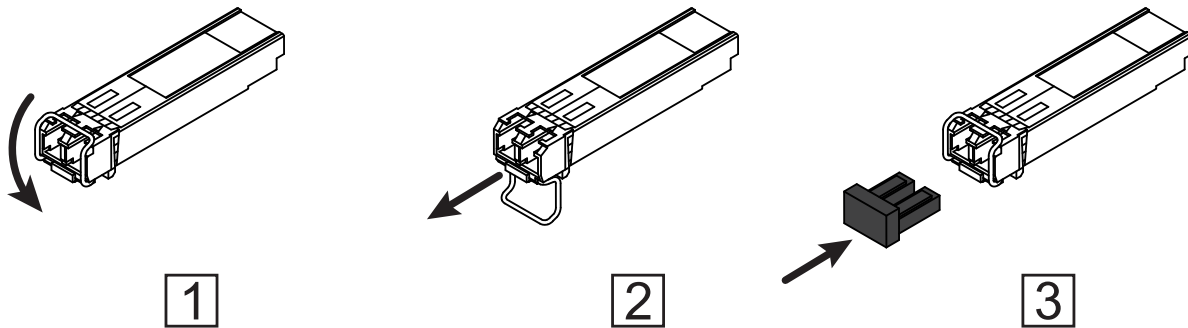
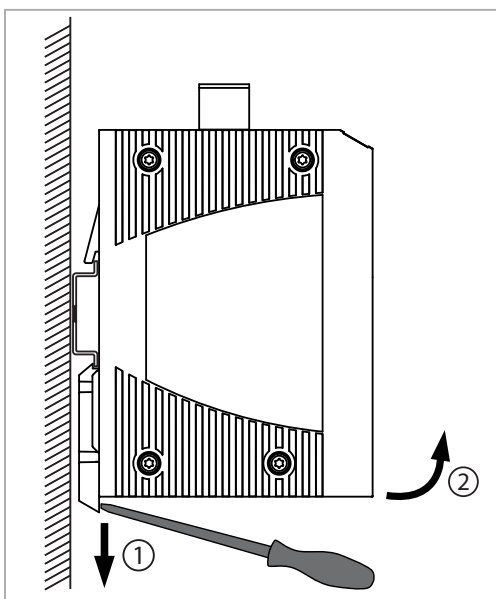

Figure 4: De-installing SFP transceivers: De-installation sequence

#### Perform the following work steps:

- ☐ Open the locking mechanism of the SFP transceiver (1).
- ☐ Pull the SFP transceiver out of the slot via the open locking mechanism (2).
- ☐ Close the SFP transceiver with the protection cap (3).

### 5.2 Removing the device





Perform the following work steps:

- ☐ Disconnect the data cables.
- ☐ Disable the supply voltage.
- ☐ Remove the terminal connector from the device.
- ☐ Use a screwdriver to pull the rail lock slide downwards.
- ☐ Pull the device downwards from the DIN rail module.

## 6 Technical data

### ■ General technical data

Dimensions W × H × D	SPIDER Standard Line	See "Dimension drawings" on page 35.
Weight	SPIDER-SL-20-01T1...	120 g (4.23 oz)
	SPIDER-SL-20-04T1...	130 g (4.59 oz)
	SPIDER-SL-20-06T1M29...	225 g (7.94 oz)
	SPIDER-SL-20-06T1S29...	225 g (7.94 oz)
	SPIDER-SL-20-06T1M2M...	230 g (8.11 oz)
	SPIDER-SL-20-06T1S2S...	235 g (8.3 oz)
	SPIDER-SL-20-05T1...	125 g (4.41 oz)
	SPIDER-SL-20-08T1...	155 g (5.47 oz)
	SPIDER-SL-40-05T1...	140 g (4.94 oz)
	SSR40-5TX	140 g (4.94 oz)
	SPIDER-SL-40-06T1O69...	235 g (8.3 oz)
	SPIDER-SL-40-06T1O6O...	240 g (8.47 oz)
	SSR40-6TX/2SFP	240 g (8.47 oz)
	SPIDER-SL-40-08T1...	170 g (6 oz)
	SSR40-8TX	170 g (6 oz)
Power supply	<ul style="list-style-type: none"> <li>▶ 1 voltage input</li> <li>▶ 3-pin terminal block</li> <li>▶ Safety extra-low voltage (SELV)</li> </ul>	
	Rated voltage range	12 V DC ... 24 V DC Class 2
	Voltage range incl. maximum tolerances	9.6 V DC ... 32 V DC
	Power loss buffer	10 ms at 20.4 V DC
	Back-up fuse	2 A ... 4 A, slow blow
	Peak inrush current	4 A
Potential difference between input voltage and ground connection	Potential difference from incoming voltage +24 V DC	+32 V DC
	Potential difference from incoming voltage, ground	-32 V DC
Climatic conditions during operation	Ambient air temperature <sup>a</sup>	0 °C ... +60 °C (+32 °F ... +140 °F) Derating <sup>b</sup>
	Humidity	10 % ... 95 % (non-condensing)
	Air pressure	min. 795 hPa (+2000 m ASL; +6562 ft ASL)
Climatic conditions during storage	Ambient air temperature <sup>a</sup>	-40 °C ... +70 °C (-40 °F ... +158 °F)
	Humidity	10 % ... 95 % (non-condensing)
	Air pressure	min. 700 hPa (+3000 m ASL; +9842 ft ASL)
Pollution degree		2
Protection classes	Degree of protection	IP30

a. Temperature of the ambient air at a distance of 5 cm (2 in) from the device

- b. For device variants SPIDER SL-40-06T1O6O699SZ9HHHH and SSR40-6TX/2SFP, the maximum permitted ambient air temperature has to be reduced to +50 °C (+122 °F).

## ■ Dimension drawings

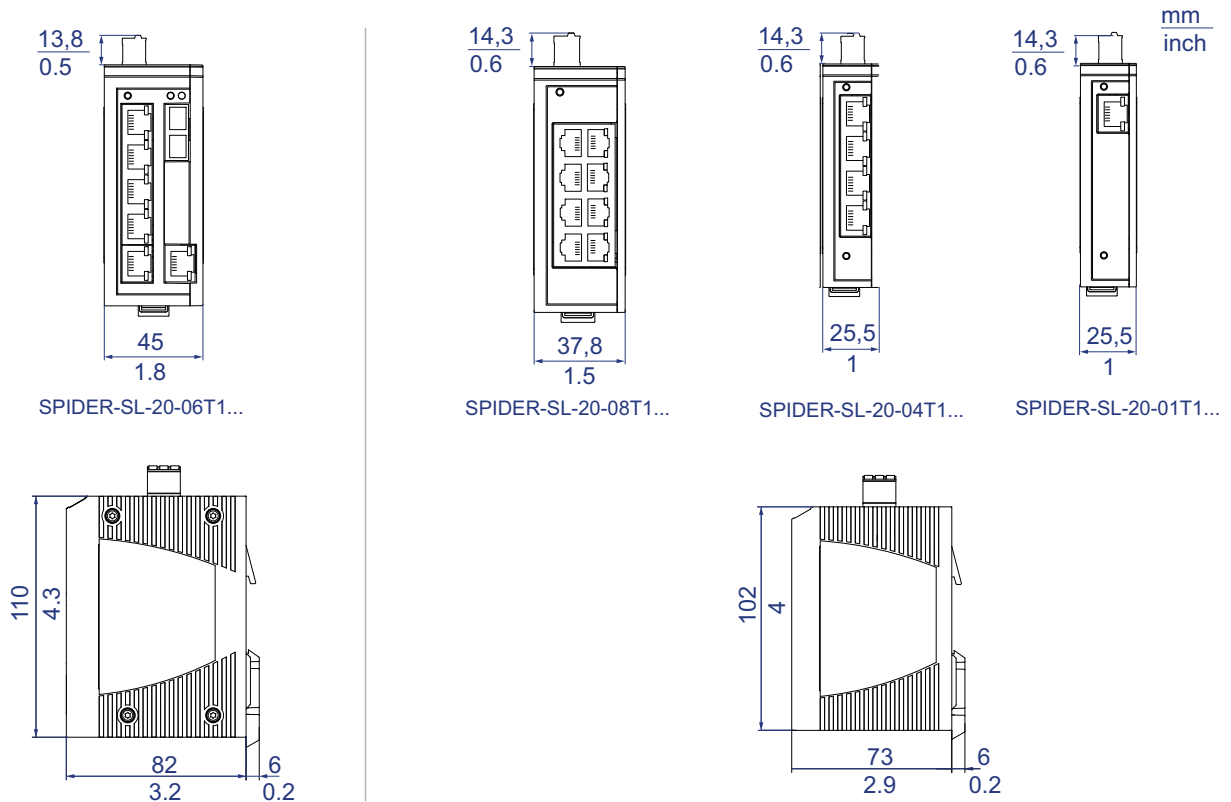

Figure 5: Dimensions of device variants SPIDER-SL-20...

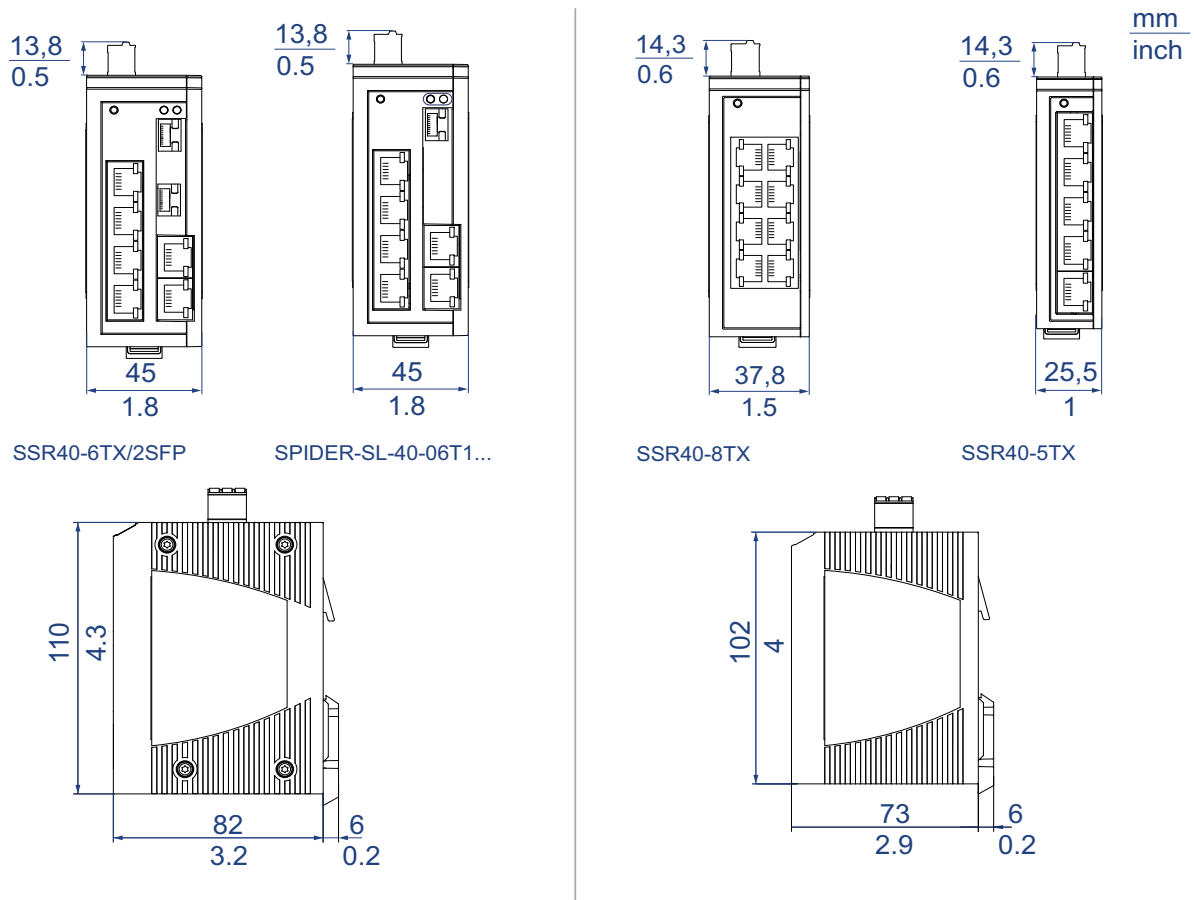

Figure 6: Dimensions of device variants SPIDER-SL-40...

## ■ EMC and immunity

**Note:** Use shielded data cables for gigabit transmission via copper cables. Use shielded data cables for all transmission rates to meet the requirements according to EN 50121-4 and marine applications.

<b>EMC interference emission</b>		
<b>Radiated emission</b>		
FCC 47 CFR Part 15		Class A
EN 55032		Class A
<b>Conducted emission</b>		
FCC 47 CFR Part 15		Class A
EN 55032		Class A
<b>EMC interference immunity</b>		
<b>Electrostatic discharge</b>		
EN 61000-4-2	Contact discharge	±4 kV
IEEE C37.90.3		
EN 61000-4-2	Air discharge	±8 kV
IEEE C37.90.3		
<b>Electromagnetic field</b>		
EN 61000-4-3	80 MHz ... 3000 MHz	max. 10 V/m
<b>Fast transients (burst)</b>		
EN 61000-4-4	DC supply connection	2 kV
IEEE C37.90.1		
EN 61000-4-4	Data line	4 kV
IEEE C37.90.1		
<b>Voltage surges - DC supply connection</b>		
EN 61000-4-5	line/ground	2 kV
EN 61000-4-5	line/line	1 kV
<b>Voltage surges - data line</b>		
EN 61000-4-5	line/ground	1 kV
<b>Conducted disturbances</b>		
EN 61000-4-6	150 kHz ... 80 MHz	10 V
<b>Immunity</b>		
IEC 60068-2-6, test Fc	Vibration	5 Hz ... 8.4 Hz with 3.5 mm amplitude
		8.4 Hz ... 150 Hz with 1 g
IEC 60068-2-27, test Ea	Shock	15 g at 11 ms

## ■ Network range

### 10/100/1000 Mbit/s twisted pair port

Length of a twisted pair segment max. 100 m (328 ft) (for Cat5e cable)

Table 5: Network range: 10/100/1000 Mbit/s twisted pair port

## ■ Power consumption/power output at 24 V DC

Device name	Max. power consumption	Power output
SPIDER-SL-20-01T1...	2.0 W	7.0 Btu(IT)/h
SPIDER-SL-20-04T1...	2.4 W	8.3 Btu(IT)/h
SPIDER-SL-20-05T1...	1.3 W	4.6 Btu(IT)/h
SPIDER-SL-20-06T1.....9...	2.8 W	9.5 Btu(IT)/h
SPIDER-SL-20-06T1.....2...	3.8 W	12.8 Btu(IT)/h
SPIDER-SL-20-08T1...	1.5 W	5.3 Btu(IT)/h
SPIDER-SL-40-05T1...	4.0 W	13.7 Btu(IT)/h
SSR40-5TX	3.1 W	10.6 Btu(IT)/h
SPIDER-SL-40-06T1....99...	8.7 W	29.6 Btu(IT)/h
SPIDER-SL-40-06T1....O6...	13.3 W	45.4 Btu(IT)/h
SSR40-6TX/2SFP	6.8 W	23.2 Btu(IT)/h
SPIDER-SL-40-08T1...	5.0 W	17.1 Btu(IT)/h
SSR40-8TX	4.1 W	14.0 Btu(IT)/h

## ■ Scope of delivery

Amount	Article
1 ×	Device
1 ×	3-pin, pluggable terminal block for power supply
1 ×	Safety and general information sheet

## ■ Order number

Device	Order number
SPIDER-SL-20-01T1M29999SZ9HHHH	942-132-005
SPIDER-SL-20-01T1S29999SZ9HHHH	942-132-006
SPIDER-SL-20-04T1M29999SZ9HHHH	942-132-007
SPIDER-SL-20-04T1M49999SZ9HHHH	942-132-008
SPIDER-SL-20-04T1S29999SZ9HHHH	942-132-009
SPIDER-SL-20-06T1M29999SZ9HHHH	942-132-010
SPIDER-SL-20-06T1S29999SZ9HHHH	942-132-011
SPIDER-SL-20-06T1M2M299SZ9HHHH	942-132-012
SPIDER-SL-20-06T1S2S299SZ9HHHH	942-132-013
SPIDER-SL-20-05T1999999SZ9HHHH	942-132-001

Device	Order number
SPIDER-SL-20-08T1999999SZ9HHHH	942-132-002
SPIDER-SL-40-05T1999999SZ9HHHH	942-132-003
SSR40-5TX (SPIDER-SL-40-05T1999999SxxxxHHxx)	942-335-003
SPIDER-SL-40-06T1O69999SZ9HHHH	942-132-014
SPIDER-SL-40-06T1O6O699SZ9HHHH	942-132-015
SSR40-6TX/2SFP (SPIDER-SL-40-06T1O6O699SxxxxHHxx)	942-335-015
SPIDER-SL-40-08T1999999SYZ9HHHH	942-132-004
SSR40-8TX (SPIDER-SL-40-08T1999999SxxxxHHxx)	942-335-004

## ■ Accessories

Note that products recommended as accessories may have different characteristics to those of the device, which may limit the application range of the overall system. For example, if you add an accessory with IP20 to a device with IP65, the degree of protection of the overall system is reduced to IP20.

Other accessories	Order number
3-pin Low Voltage Interlock terminal block (50 pcs.)	943 845-005
Rail Power Supply RPS 30	943 662-003
Rail Power Supply RPS 80 EEC	943 662-080
Rail Power Supply RPS 120 EEC (CC)	943 662-121
Wall mounting plate for DIN rail mounting, width 40 mm (1.58 in)	942 177-001
Wall mounting plate for DIN rail mounting, width 70 mm (2.76 in)	942 177-002

**Note:** To operate the device in the maximum permitted ambient air temperature as mentioned in [“General technical data” on page 34](#), exclusively use the EEC variants of the SFP transceivers listed below. When using listed below SFP transceivers without EEC rating, the maximum permitted ambient air temperature during operation of the SPIDER-SL has to be reduced by 15 K.

Fast-Ethernet-SFP-Transceiver	Order number
M-FAST SFP-TX/RJ45	942 098-001
M-FAST SFP-TX/RJ45 EEC	942 098-002
M-FAST SFP-MM/LC	943 865-001
M-FAST SFP-MM/LC EEC	943 945-001
M-FAST SFP-SM/LC	943 866-001
M-FAST SFP-SM/LC EEC	943 946-001
M-FAST SFP-SM+/LC	943 867-001
M-FAST SFP-SM+/LC EEC	943 947-001
M-FAST SFP-LH/LC	943 868-001
M-FAST SFP-LH/LC EEC	943 948-001
SFP-FAST-MM/LC <sup>a</sup>	942 194-001
SFP-FAST-MM/LC EEC <sup>a</sup>	942 194-002

<b>Fast-Ethernet-SFP-Transceiver</b>	<b>Order number</b>
SFP-FAST-SM/LC <sup>a</sup>	942 195-001
SFP-FAST-SM/LC EEC <sup>a</sup>	942 195-002
SFP-FAST-BA MM/LC EEC	942 204-001
SFP-FAST-BB MM/LC EEC	942 204-002
SFP-FAST-BA SM/LC EEC	942 205-001
SFP-FAST-BB SM/LC EEC	942 205-002
SFP-FAST-BA SM+/LC EEC	942 206-001
SFP-FAST-BB SM+/LC EEC	942 206-002

a. You find further information on certifications on the Internet at the Hirschmann product pages ([www.hirschmann.com](http://www.hirschmann.com)).

<b>Bidirectional Gigabit Ethernet SFP transceiver</b>	<b>Order number</b>
M-SFP-BIDI Type A LX/LC EEC	943 974-001
M-SFP-BIDI Type B LX/LC EEC	943 974-002
M-SFP-BIDI Type A LH/LC EEC	943 975-001
M-SFP-BIDI Type B LH/LC EEC	943 975-002
M-SFP-BIDI Bundle LX/LC EEC (Type A + B)	943 974-101
M-SFP-BIDI Bundle LH/LC EEC (Type A + B)	943 975-101

*Table 6: Accessory: Bidirectional Gigabit Ethernet SFP transceiver*

<b>Gigabit Ethernet SFP transceiver</b>	<b>Order number</b>
M-SFP-TX/RJ45	943 977-001
M-SFP-TX/RJ45 EEC	943 161-001
M-SFP-SX/LC	943 014-001
M-SFP-SX/LC EEC	943 896-001
M-SFP-MX/LC EEC	942 108-001
M-SFP-LX/LC	943 015-001
M-SFP-LX/LC EEC	943 897-001
M-SFP-LX+/LC	942 023-001
M-SFP-LX+/LC EEC	942 024-001
M-SFP-LH/LC	943 042-001
M-SFP-LH/LC EEC	943 898-001
M-SFP-LH+/LC	943 049-001
M-SFP-LH+/LC EEC	943 119-001
SFP-GIG-LX/LC <sup>a</sup>	942 196-001
SFP-GIG-LX/LC EEC <sup>a</sup>	942 196-002
SFP-GIG-BA LX/LC EEC	942 207-001
SFP-GIG-BB LX/LC EEC	942 207-002
SFP-GIG-BA LX+/LC EEC	942 208-001
SFP-GIG-BB LX+/LC EEC	942 208-002
SFP-GIG-BA LH/LC EEC	942 209-001
SFP-GIG-BB LH/LC EEC	942 209-002

a. You find further information on certifications on the Internet at the Hirschmann product pages ([www.hirschmann.com](http://www.hirschmann.com)).



## ■ Underlying technical standards

Name	
CSA C22.2 No. 142	Canadian National Standard(s) – Process Control Equipment – Industrial Products
EN 50121-4	Railway applications – EMC – Emission and immunity of the signaling and telecommunications apparatus (Rail Trackside)
EN 55032	Electromagnetic compatibility of multimedia equipment – Emission Requirements
EN 61000-6-2	Electromagnetic compatibility (EMC) – Part 6-2: Generic standards – Immunity for industrial environments
EN 61131-2	Programmable controllers – Part 2: Equipment requirements and tests
FCC 47 CFR Part 15	Code of Federal Regulations
IEC 60950-1	Information technology equipment – Safety – Part 1: General requirements
UL 61010-2-201	Safety requirements for electrical equipment for measurement, control, and laboratory use - Part 2-201: Particular requirements for control equipment

*Table 7: List of the technical standards*

The device has an approval based on a specific standard exclusively if the approval indicator appears on the device casing.

The device generally fulfills the technical standards named in their current versions.

## **A Open Source Software used in the product**

The product contains, among other things, Open Source Software files, as defined below, developed by third parties and licensed under an Open Source Software license.

These Open Source Software files are protected by copyright. Your right to use the Open Source Software is governed by the relevant applicable Open Source Software license conditions

Your compliance with those license conditions will entitle you to use the Open Source Software as foreseen in the relevant license. In the event of conflicts between other Hirschmann Automation and Control GmbH license conditions applicable to the product and the Open Source Software license conditions, the Open Source Software conditions shall prevail. The Open Source Software is provided royalty-free (i.e. no fees are charged for exercising the licensed rights). Open Source Software contained in this product and the respective Open Source Software licenses are stated below.

If Open Source Software contained in this product is licensed under GNU General Public License (GPL), GNU Lesser General Public License (LGPL), Mozilla Public License (MPL) or any other Open Source Software license, which requires that source code is to be made available and such source code is not already delivered together with the product, you can order the corresponding source code of the Open Source Software from Hirschmann Automation and Control GmbH - against payment of the shipping and handling charges - for a period of at least 3 years since purchase of the product. Please send your specific request, within three years of the purchase date of this product, together with the name and ID number of the product to be found at the label of the product to:

Hirschmann Automation and Control GmbH  
Head of R&D  
Stuttgarter Str. 45-51  
72654 Neckartenzlingen  
Germany

### **Warranty regarding further use of the Open Source Software**

Hirschmann Automation and Control GmbH provides no warranty for the Open Source Software contained in this product, if such Open Source Software is used in any manner other than intended by Hirschmann Automation and Control GmbH. The licenses listed below define the warranty, if any, from the authors or licensors of the Open Source Software.

Hirschmann Automation and Control GmbH specifically disclaims any warranty for defects caused by altering any Open Source Software or the product's configuration. Any warranty claims against Hirschmann Automation and Control GmbH in the event that the Open Source Software contained in this product infringes the intellectual property rights of a third party are excluded.

Technical support, if any, will only be provided for unmodified software.

### **Software contained in the product**

The following software components are part of the product depending on the product and its feature set:

Component Name: Atmel Advanced Software Framework (ASF)

License: Atmel ASF License

Version: 3.25.0

Source Link: <https://www.microchip.com/en-us/tools-resources/develop/libraries/advanced-software-framework>

Component Name: BSD-style license

License: BSD-style license

Version: R0.09

Source Link: <http://elm-chan.org/fsw/ff/archives.html>

Component Name: ARM Cortex Microcontroller Software Interface Standard (CMSIS)

License: ARM CMSIS License

Version: 3.00

Source Link: <http://packs.download.atmel.com/>

Component Name: Universal Marvell SOHO Driver (UMSD)

License: BSD3 license

### **The Licenses in Detail**

#### **Atmel Advanced Software Framework (ASF)**

Copyright (c) 2014 Atmel Corporation. All rights reserved.

Redistribution and use in source and binary forms, with or without modification, are permitted provided that the following conditions are met:

- 1) Redistributions of source code must retain the above copyright notice, this list of conditions and the following disclaimer.
- 2) Redistributions in binary form must reproduce the above copyright notice, this list of conditions and the following disclaimer in the documentation and/or other materials provided with the distribution.
- 3) The name of Atmel may not be used to endorse or promote products derived from this software without specific prior written permission.
- 4) This software may only be redistributed and used in connection with an Atmel microcontroller product.

THIS SOFTWARE IS PROVIDED BY ATMEL "AS IS" AND ANY EXPRESS OR IMPLIED WARRANTIES, INCLUDING, BUT NOT LIMITED TO, THE IMPLIED WARRANTIES OF MERCHANTABILITY, FITNESS FOR A PARTICULAR PURPOSE AND NON-INFRINGEMENT ARE EXPRESSLY AND SPECIFICALLY DISCLAIMED. IN NO EVENT SHALL ATMEL BE LIABLE OR ANY DIRECT, INDIRECT, INCIDENTAL, SPECIAL, EXEMPLARY, OR CONSEQUENTIAL DAMAGES (INCLUDING, BUT NOT LIMITED TO, PROCUREMENT OF SUBSTITUTE GOODS OR SERVICES; LOSS OF USE, DATA, OR PROFITS; OR BUSINESS INTERRUPTION) HOWEVER CAUSED AND ON ANY THEORY OF LIABILITY, WHETHER IN CONTRACT, STRICT LIABILITY, OR TORT (INCLUDING NEGLIGENCE OR OTHERWISE) ARISING IN ANY WAY OUT OF THE USE OF THIS SOFTWARE, EVEN IF ADVISED OF THE POSSIBILITY OF SUCH DAMAGE.

### **FAT file system (FatFs)**

FatFs - FAT file system module R0.09  
(C)ChaN, 2011

FatFs module is a generic FAT file system module for small embedded systems. This is a free software that opened for education, research and commercial developments under license policy of following terms.

Copyright (C) 2011, ChaN, all right reserved.

The FatFs module is a free software and there is NO WARRANTY. No restriction on use. You can use, modify and redistribute it for personal, non-profit or commercial products UNDER YOUR RESPONSIBILITY. Redistributions of source code must retain the above copyright notice.

### **ARM Cortex Microcontroller Software Interface Standard (CMSIS)**

Copyright (C) 2009-2012 ARM Limited. All rights reserved.

ARM Limited (ARM) is supplying this software for use with Cortex-M processor based microcontrollers. This file can be freely distributed within development tools that are supporting such ARM based processors.

THIS SOFTWARE IS PROVIDED "AS IS" NO WARRANTIES, WHETHER EXPRESS, IMPLIED OR STATUTORY, INCLUDING, BUT NOT LIMITED TO, IMPLIED WARRANTIES OF MERCHANTABILITY AND FITNESS FOR A PARTICULAR PURPOSE APPLY TO THIS SOFTWARE. ARM SHALL NOT, IN ANY CIRCUMSTANCES, BE LIABLE FOR SPECIAL, INCIDENTAL, OR CONSEQUENTIAL DAMAGES, FOR ANY REASON WHATSOEVER.

CMSIS is released under the terms of the end user license agreement ("CMSIS END USER LICENCE AGREEMENT.pdf"). Any user of the software package is bound to the terms and conditions of the end user license agreement.

## END USER LICENCE AGREEMENT FOR THE CORTEX MICROCONTROLLER SOFTWARE INTERFACE STANDARD (CMSIS) SPECIFICATION AND SOFTWARE

THIS END USER LICENCE AGREEMENT (“LICENCE”) IS A LEGAL AGREEMENT BETWEEN YOU (EITHER A SINGLE INDIVIDUAL, OR SINGLE LEGAL ENTITY) AND ARM LIMITED (“ARM”) FOR THE USE OF THE CMSIS SPECIFICATION, EXAMPLE CODE, DSP LIBRARY SPECIFICATION AND DSP LIBRARY IMPLEMENTATION AS SUCH TERMS ARE DEFINED BELOW (COLLECTIVELY, THE “ARM DELIVERABLES”). ARM IS ONLY WILLING TO LICENSE THE ARM DELIVERABLES TO YOU ON CONDITION THAT YOU ACCEPT ALL OF THE TERMS IN THIS LICENCE. BY CLICKING “I AGREE”, OR BY INSTALLING OR OTHERWISE USING OR COPYING THE ARM DELIVERABLES YOU INDICATE THAT YOU AGREE TO BE BOUND BY ALL THE TERMS OF THIS LICENCE. IF YOU DO NOT AGREE TO THE TERMS OF THIS LICENCE, ARM IS UNWILLING TO LICENSE YOU TO USE THE ARM DELIVERABLES AND YOU MAY NOT INSTALL, USE OR COPY THE ARM DELIVERABLES.

“CMSIS Specification” means any documentation and C programming language files defining the application programming interface, naming and coding conventions of the Cortex Microcontroller Software Interface Standard (CMSIS) as well as the System View Description (SVD) documentation and associated XML schema file. Notwithstanding the foregoing, “CMSIS Specification” shall not include (i) the implementation of other published specifications referenced in the CMSIS Specification; (ii) any enabling technologies that may be necessary to make or use any product or portion thereof that complies with the CMSIS Specification, but are not themselves expressly set forth in the CMSIS Specification (e.g. compiler front ends, code generators, back ends, libraries or other compiler, assembler or linker technologies; validation or debug software or hardware; applications, operating system or driver software; RISC architecture; processor microarchitecture); (iii) maskworks and physical layouts of integrated circuit designs; or (iv) RTL or other high level representations of integrated circuit designs.

“DSP Library Implementation” means any C programming language source code implementing the functionality of the digital signal processor (DSP) algorithms and the application programming interface as defined in the DSP Library Specification. The DSP Library Implementation makes use of CMSIS application programming interface and therefore is targeted at Cortex-M class processors.

“DSP Library Specification” means the DSP library documentation and C programming language file defining the application programming interface of the DSP Library Implementation. Notwithstanding the foregoing, “DSP Library Specification” shall not include (i) the implementation of other published specifications referenced in the DSP Library Specification; (ii) any enabling technologies that may be necessary to make or use any product or portion thereof that complies with the DSP Library Specification, but are not themselves expressly set forth in the DSP Library Specification (e.g. compiler front ends, code generators, back ends, libraries or other compiler, assembler or linker technologies; validation or debug software or hardware; applications, operating system or driver software; RISC architecture; processor microarchitecture); (iii) maskworks and physical layouts of integrated circuit designs; or (iv) RTL or other high level representations of integrated circuit designs.

“Example Code” means any files in C, C++ or ARM assembly programming languages, associated project and configuration files that demonstrate the usage of the CMSIS Specification, the DSP Library Specification and the DSP Library Implementation, for microprocessors or device specific software applications that are for use with microprocessors.

## LICENCE GRANTS.

1.1 ARM hereby grants to you, subject to the terms and conditions of this Licence, a non-exclusive, nontransferable licence, to;

(i) use and copy the CMSIS Specification for the purpose of developing, having developed, manufacturing, having manufactured, offering to sell, selling, supplying or otherwise distributing products that comply with the CMSIS Specification, provided that you preserve any copyright notices which are included with, or in, the CMSIS Specification and provided that you do not use ARM's name, logo or trademarks to market such products;

(ii) use, copy, and modify (solely to the extent necessary to incorporate the whole or any part of the DSP Library Specification into your documentation), the DSP Library Specification, for the purpose of developing, having developed, manufacturing, having manufactured, offering to sell, selling, supplying or otherwise distributing products that comply with the DSP Library Specification, and distribute and have distributed any documentation created by or for you that has been derived from the DSP Library Specification with such products, provided that you preserve any copyright notices which are included with, or in, the DSP Library Specification and provided that you do not use ARM's name, logo or trademarks to market such products;

(iii) use, copy, modify and sublicense the Example Code solely for the purpose of developing, having developed, manufacturing, having manufactured, offering to sell, selling, supplying or otherwise distributing products that comply with either or both the CMSIS Specification and the DSP Library Specification, provided that you preserve any copyright notices which are included with, or in, the Example Code and that you do not use ARM's name, logo or trademarks to market such products;

(iv) use, copy and modify (provided that the logical functionality and the application programming interface of the DSP Library Implementation are maintained) the DSP Library Implementation, solely for the purposes of developing; (a) software applications for use with microprocessors manufactured or simulated under licence from ARM ("Software Applications"); and (b) tools that are designed to develop software programs for use with microprocessors manufactured or simulated under licence from ARM ("Tools"); and

(v) subject to clause 1.1(vi) below; (a) distribute and sublicense the use of the DSP Library Implementation (including any modified forms thereof created under Clause 1.1(iv) above) in binary or source format, solely as incorporated into Software Library Applications and Tools to third parties; and (b) sublicense to such third parties the right to use and copy the Tools for the purposes of developing and distribute software programs for use with microprocessors manufactured or simulated under licence from ARM.

(vi) CONDITIONS ON REDISTRIBUTION: If you choose to redistribute the whole or any part of the DSP Library Implementation as incorporated into Software Library Applications or Tools, you agree to; (a) ensure that the DSP Library Implementation is licensed for use only as part of Software Library Applications and Tools and only for use with microprocessors manufactured or simulated under licence from ARM; (b) not to use ARM's name, logo or trademarks to market Software Applications and Tools; and (c) include valid copyright notices on Software Applications and Tools, and preserve any copyright notices which are included with, or in, the DSP Library Implementation.

## 2. RESTRICTIONS ON USE OF THE ARM DELIVERABLES.

PERMITTED USERS: The ARM Deliverables shall be used only by you (either a single individual, or single legal entity) your employees, or by your on-site bona fide sub-contractors for whose acts and omissions you hereby agree to be responsible to ARM for to the same extent as you are for your employees, and provided always that such sub-contractors; (i) are contractually obligated to use the ARM Deliverables only for your benefit, and (ii) agree to assign all their work product and any rights they create therein in the supply of such work to you.

**COPYRIGHT AND RESERVATION OF RIGHTS:** The ARM Deliverables are owned by ARM or its licensors and are protected by copyright and other intellectual property laws and international treaties. The ARM Deliverables are licensed not sold. Except as expressly licensed herein, you acquire no right, title or interest in the ARM Deliverables or any intellectual property therein. In no event shall the licences granted herein be construed as granting you, expressly or by implication, estoppels or otherwise, a licence to use any ARM technology except the ARM Deliverables.

### 3. SUPPORT.

ARM is not obligated to support the ARM Deliverables but may do so entirely at ARM's discretion.

### 4. NO WARRANTY

YOU AGREE THAT THE ARM DELIVERABLES ARE LICENSED "AS IS", AND THAT ARM EXPRESSLY DISCLAIMS ALL REPRESENTATIONS, WARRANTIES, CONDITIONS OR OTHER TERMS, EXPRESS, IMPLIED OR STATUTORY, INCLUDING WITHOUT LIMITATION THE IMPLIED WARRANTIES OF NONINFRINGEMENT, SATISFACTORY QUALITY, AND FITNESS FOR A PARTICULAR PURPOSE. THE ARM DELIVERABLES MAY CONTAIN ERRORS. ARM RESERVES THE RIGHT TO INCORPORATE MODIFICATIONS TO THE ARM DELIVERABLES IN LATER REVISIONS OF THEM, AND TO MAKE IMPROVEMENTS OR CHANGES IN THE ARM DELIVERABLES AT ANY TIME.

### 5. LIMITATION OF LIABILITY

THE MAXIMUM LIABILITY OF ARM TO YOU IN AGGREGATE FOR ALL CLAIMS MADE AGAINST ARM IN CONTRACT, TORT OR OTHERWISE UNDER OR IN CONNECTION WITH THE SUBJECT MATTER OF THIS LICENCE SHALL NOT EXCEED THE GREATER OF (I) THE TOTAL OF SUMS PAID BY YOU TO ARM (IF ANY) FOR THIS LICENCE AND (II) US\$10.00. THE LIMITATIONS, EXCLUSIONS AND DISCLAIMERS IN THIS LICENCE SHALL APPLY TO THE MAXIMUM EXTENT ALLOWED BY APPLICABLE LAW.

### 6. U.S. GOVERNMENT END USERS

US Government Restrictions: Use, duplication, reproduction, release, modification, disclosure or transfer of this commercial product and accompanying documentation is restricted in accordance with the terms of this Licence.

### 7. TERM AND TERMINATION

7.1 This Licence shall remain in force until terminated in accordance with the terms of Clause 7.2 or Clause 7.3 below.

7.2 Without prejudice to any of its other rights if you are in breach of any of the terms and conditions of this Licence then ARM may terminate this Licence immediately upon giving written notice to you. You may terminate this Licence at any time.



7.3 This Licence shall immediately terminate and shall be unavailable to you if you or any party affiliated to you asserts any patents against ARM, ARM affiliates, third parties who have a valid licence from ARM for the ARM Deliverables, or any customers or distributors of any of them based upon a claim that your (or your affiliate) patent is Necessary to implement the CMSIS Specification or DSP Library Specification. In this Licence; (i) "affiliate" means any entity controlling, controlled by or under common control with a party (in fact or in law, via voting securities, management control or otherwise) and "affiliated" shall be construed accordingly; (ii) "assert" means to allege infringement in legal or administrative proceedings, or proceedings before any other competent trade, arbitral or international authority; (iii) "Necessary" means with respect to any claims of any patent, those claims which, without the appropriate permission of the patent owner, will be infringed when implementing the CMSIS Specification or DSP Library Specification because no alternative, commercially reasonable, noninfringing way of implementing the CMSIS Specification or DSP Library Specification is known.

7.4 Upon termination of this Licence, you shall stop using the ARM Deliverables and destroy all copies of the ARM Deliverables in your possession. The provisions of clauses 5, 6, 7, and 8 shall survive termination of this Licence.

#### 8. GENERAL.

This Licence is governed by English Law. Except where ARM agrees otherwise in a written contract signed by you and ARM, this is the only agreement between you and ARM relating to the ARM Deliverables and it may only be modified by written agreement between you and ARM. Except as expressly agreed in writing, this Licence may not be modified by purchase orders, advertising or other representation by any person. If any clause or sentence in this Licence is held by a court of law to be illegal or unenforceable the remaining provisions of this Licence shall not be affected thereby. The failure by ARM to enforce any of the provisions of this Licence, unless waived in writing, shall not constitute a waiver of ARM's rights to enforce such provision or any other provision of this Licence in the future. This Licence may not be assigned without the prior written consent of ARM.

ARM contract reference LEC-PRE-00489-V6.0

06 December, 2010

### **BSD3**

Copyright (c) 2020 Marvell Semiconductor Ltd. All rights reserved.

Redistribution and use in source and binary forms, with or without modification, are permitted provided that the following conditions are met:

- 1) Redistributions of source code must retain the above copyright notice, this list of conditions and the following disclaimer.
- 2) Redistributions in binary form must reproduce the above copyright notice, this list of conditions and the following disclaimer in the documentation and/or other materials provided with the distribution.
- 3) Neither the name of the copyright holder nor the names of its contributors may be used to endorse or promote products derived from this software without specific prior written permission.

THIS SOFTWARE IS PROVIDED BY THE COPYRIGHT HOLDERS AND CONTRIBUTORS "AS IS" AND ANY EXPRESS OR IMPLIED WARRANTIES, INCLUDING, BUT NOT LIMITED TO, THE IMPLIED WARRANTIES OF MERCHANTABILITY AND FITNESS FOR A PARTICULAR PURPOSE ARE DISCLAIMED. IN NO EVENT SHALL THE COPYRIGHT HOLDER AND CONTRIBUTORS BE LIABLE FOR ANY DIRECT, INDIRECT, INCIDENTAL, SPECIAL, EXEMPLARY, OR CONSEQUENTIAL DAMAGES (INCLUDING, BUT NOT LIMITED TO, PROCUREMENT OF SUBSTITUTE GOODS OR SERVICES; LOSS OF USE, DATA, OR PROFITS; OR BUSINESS INTERRUPTION) HOWEVER CAUSED AND ON ANY THEORY OF LIABILITY, WHETHER IN CONTRACT, STRICT LIABILITY, OR TORT (INCLUDING NEGLIGENCE OR OTHERWISE) ARISING IN ANY WAY OUT OF THE USE OF THIS SOFTWARE, EVEN IF ADVISED OF THE POSSIBILITY OF SUCH DAMAGE.

## B Further support

### Technical questions

For technical questions, please contact any Hirschmann dealer in your area or Hirschmann directly.

You find the addresses of our partners on the Internet at <http://www.hirschmann.com>.

A list of local telephone numbers and email addresses for technical support directly from Hirschmann is available at <https://hirschmann-support.belden.com>.

This site also includes a free of charge knowledge base and a software download section.

### Customer Innovation Center

The Customer Innovation Center is ahead of its competitors on three counts with its complete range of innovative services:

- ▶ Consulting incorporates comprehensive technical advice, from system evaluation through network planning to project planning.
- ▶ Training offers you an introduction to the basics, product briefing and user training with certification.  
You find the training courses on technology and products currently available at <https://www.belden.com/solutions/customer-innovation-center>.
- ▶ Support ranges from the first installation through the standby service to maintenance concepts.

With the Customer Innovation Center, you decide against making any compromises in any case. Our client-customized package leaves you free to choose the service components you want to use.

Internet:

<https://www.belden.com/solutions/customer-innovation-center>



**HIRSCHMANN**

---

A **BELDEN** BRAND